

SSC(INCH) Socket Head Cap Captive Screws (Inch Screws)

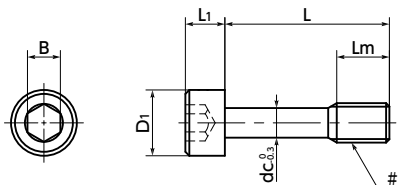

WEB Selection Tool WEB CAD Download SUS Stainless steel



⚠ Precautions for Use

- Screw hole inner diameter on the cover side shall be at least the dc dimension.
- The cover thickness should be 0.8 mm or above.
- Installation example

Machine a screw hole on the cover and let through the threaded part of **SSC(INCH)**. Threaded part of **SSC(INCH)** is still engaged with the screw hole on the cover even after the screw is removed from the frame, so **SSC(INCH)** never fall out of the cover.

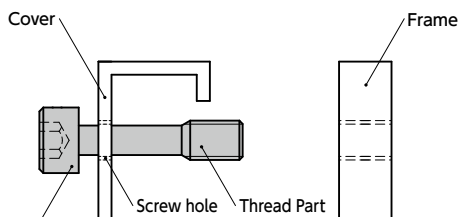

SSC(INCH) Socket Head Cap Captive Screw (Inch Screws)

- It prevents fall-off and loss of the screw. For fixing of protection cover and cover for inspection that are frequently mounted and removed.
- Inch screw type.
- For CE marking. → P.xxxx
- Use a dedicated wrench **SKH(INCH)** for mounting and removal. → P.xxxx
- We also produce captive screws of special specifications, e.g. dimensions, shapes, materials and surface treatment. Please feel free to contact our customer service.



● Application

Fixing of protection cover and cover for inspection / CE marking
Machine tool / Food machinery / and Electronic device

● Material/Finish

RoHS2 Compliant

	SSC (INCH)
Main body	Equivalent to SUS304
Strength Class	A2-50

Part Number	1	# Nominal of Thread	L	2																Unit : inch
																				Mass (g)
SSC-#4-40		No.4-40UNC	5 / 16	3 / 8	1 / 2	5 / 8								4	0.183	0.112	3 / 32	1.9		0.63 - 0.94
SSC-#6-32		No.6-32UNC		3 / 8	1 / 2	5 / 8	3 / 4							5	0.226	0.138	7 / 64	2.4		1.2 - 1.7
SSC-#8-32		No.8-32UNC		3 / 8	1 / 2	5 / 8	3 / 4							5	0.27	0.164	9 / 64	3		1.8 - 2.7
SSC-#10-32		No.10-32UNF		3 / 8	1 / 2	5 / 8	3 / 4	7 / 8						6	0.312	0.19	5 / 32	3.7		2.7 - 4.2
SSC-1 / 4-20		1/4-20UNC				5 / 8	3 / 4	7 / 8	1	1 - 1/4	9			9	0.375	0.25	3 / 16	4.6		6.2 - 9.3

Part Number	Qty per pack 入り数
SSC-#4-40	1
SSC-#6-32	1
SSC-#8-32	1
SSC-#10-32	1
SSC-1 / 4-20	1

● Part number specification

SSC-#4-40-5/8

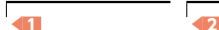

Individual Sales → P.xxxx	Cleanroom Wash & Packaging → P.xxxx	Screw Length Adjustment → P.xxxx	Vibration Resistant → P.xxxx	Modification process for captive use → P.xxxx
1 unit in 1 bag	Available / Add'l charge	Not Available	Not Available	with Captive Processing