

SPE-C Plastic Screw - Hex Socket Head Cap Screws - PEEK *Additional Size*

WEB Selection Tool | WEB CAD Download | Chemical-proof

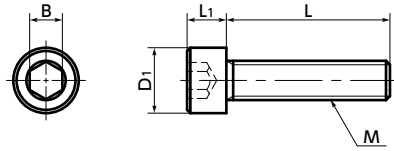

● Material/Finish

RoHS2 Compliant

	SPE-C
Main body	PEEK (Polyether Ether Ketone) (Light Brown)
Heat Resistance Temperature*1	260°C

*1: This is the value for the plastic material. The maximum operating temperature of the product changes with performance conditions such as tightening torque.

⚠ Precautions for Use

Because a cumulative pitch difference is created when PEEK screws are manufactured, use these screws with nuts. If a nut is not used, use a 20 mm or less fit with female thread.

- PEEK is a thermoplastic super - engineering plastic with excellent physical and chemical properties.
- These screws have excellent chemical resistance. They are mostly unaffected by chemicals excluding concentrate sulfuric acid, concentrate nitric acid, and concentrate hydrofluoric acid.
- These screws have excellent heat resistance, water resistance, and high heat resistance strength.
- These screws have excellent abrasion, shock, and fatigue resistance.
- They have high incombustibility that meets V - 0 of UL 94.
- The properties and precautions of plastic screws
→ P.xxxx

● Application

FPD production equipment / Semiconductor devices / Printed circuit board etching devices / Metallic surface treatment equipment and facilities / Chemical plants / Transformers / Electrical and electronic equipment / Hot water pumps / Chemical pumps

Unit : mm

Part Number	M (Coarse)		L ²										D1	L1	B	Tension*1 Rupture Load (N)	Torsional*1 Torque (N·m)	Mass (g)
	Nominal of Thread ¹	Pitch	6	8	10	12	15	20	25	30	35	40						
SPE-M3-C	M3	0.5	6	8	10	12	15	20	25	30			5.5	3	2.5	405	0.21	0.12 - 0.27
SPE-M4-C	M4	0.7	6	8	10	12	15	20	25	30			7	4	3	738	0.47	0.25 - 0.61
SPE-M5-C	M5	0.8	6	8	10	12	15	20	25	30			8.5	5	4	1234	0.96	0.37 - 0.93
SPE-M6-C	M6	1			10	12	15	20	25	30	35	40	10	6	5	1749	1.64	0.78 - 1.8
SPE-M8-C	M8	1.25			10	12	15	20	25	30	35	40	13	8	6	3261	3.68	1.8 - 3.5
SPE-M10-C	M10	1.5					15	20	25	30	35	40	16	10	8	5256	7.9	3.5 - 5.6
SPE-M12-C	M12	1.75						20	25	30	35	40	18	12	10	7650	13.64	5.5 - 8.0

*1: Values in chart are for reference only. They are not guaranteed values. The recommendation torque is 50% of the torsional torque.

Part Number	Qty per pack*1
SPE-M3-C	20
SPE-M4-C	20
SPE-M5-C	10
SPE-M6-C	10
SPE-M8-C	5
SPE-M10-C	1
SPE-M12-C	1

*1: Also sold separately from 1 piece up. → P.xxxx

Individual Sales → P.xxxx | Cleanroom Wash & Packaging → P.xxxx | Screw Length Adjustment → P.xxxx | Vibration Resistant → P.xxxx | Modification process for captive use → P.xxxx
Available / Add'l charge | Available / Add'l charge | Available / Add'l charge | Not Available | Please feel free to contact us

● Related Products

SPE-N Plastic Hexagon Nut (PEEK) is available.
→ P.xxxx



PEEK hex socket head cap screws **SPE-C(INCH)** are available as inch threads.
→ P.xxxx



● Part number specification

SPE-M5-20-C

Product Code ¹ ² Product Code

Order in number of packs.

Also sold separately from 1 piece up. → P.xxxx