

SNSP Hex Socket Head Cap Screws - Phosphor Bronze

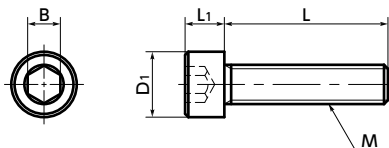

[WEB Selection Tool](#)
[WEB CAD Download](#)
[Cleanroom wash & packaging](#)
[Non-Magnetic](#)



● Mechanical property

	Phosphor Bronze (C5191)	SUS304
Tensile Strength (N/mm ²)	590 or Higher	520 or Higher
Elongation (%)	8	40 or Higher

● Values in chart are for reference only. They are not guaranteed values.

● Physical property

	Phosphor Bronze (C5191)	SUS304
Specific Gravity	8.83	7.93
Longitudinal Elastic Modulus (GPa)	105	193
Electric Resistance (μΩ · m)	0.13	0.7
Thermal Conductivity (W / (m · K))	67	17
Linear Expansion Coefficient (K ⁻¹)	18 × 10 ⁻⁶	17.3 × 10 ⁻⁶

● Values in chart are for reference only. They are not guaranteed values.

● Magnetic flux density

	Phosphor Bronze	SUSXM7 (Equivalent to SUS304)
Magnetic Flux Density (T)	0	5 × 10 ⁻⁵

Measuring device : 5080 Gauss (Tesla) Meter by F.W.BELL

Measuring conditions : DC magnetic field measuring mode

Probe and sample separation distance: 5

mm

● Non-Magnetic.

● Excellent fatigue resistance, corrosion resistance, and abrasion resistance.

● Application

FPD production equipment, semiconductor devices, and electrical and electronic equipment

● Material/Finish



	SNSP
Main Body	C5191 (Phosphor Bronze)

Unit : mm

Part Number	M	L ^②								D1	L1	B	Tension*1 Rupture Load (N)	Mass (g)
SNSP-M3	M3	6	8	10	12	16	20			5.5	3	2.5	2960	0.81 - 1.6
SNSP-M4	M4		8	10	12	16	20	25		7	4	3	5180	1.9 - 3.6
SNSP-M5	M5			10	12	16	20	25		8.5	5	4	8370	3.1 - 5.4
SNSP-M6	M6				12	16	20	25	30	10	6	5	11800	5.8 - 9.5
SNSP-M8	M8					16	20	25	30	35	13	8	21500	14 - 22

*1 : Values in chart are for reference only. They are not guaranteed values.

Part Number	Qty per Pack
SNSP-M3	1
SNSP-M4	1
SNSP-M5	1
SNSP-M6	1
SNSP-M8	1

● Part number specification

SNSP-M5 - 16

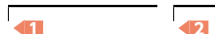

1 Individual Sales → P.0000	1 Cleanroom Wash & Packaging → P.0000	1 Screw Length Adjustment → P.0000	1 Vibration Resistant → P.0000	1 Modification process for captive use → P.0000
1 unit in 1 bag	Cleanroom washed and packed	Available / Add'l charge	Available / Add'l charge	Available / Add'l charge