

# XGS Flexible Couplings - High - gain Rubber Type (short) - Set Screw Type

[WEB Selection Tool](#)
[WEB CAD Download](#)
[Zero Backlash](#)
[High gain supported](#)
[High torque](#)
[Vibration absorption](#)

XGS

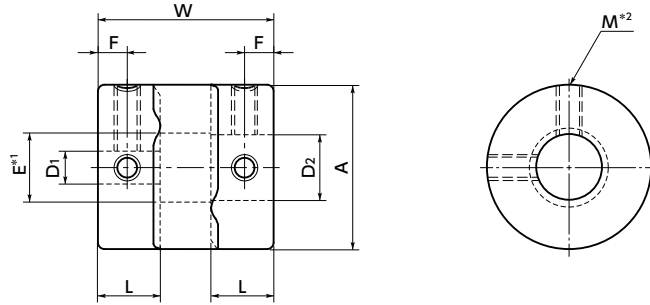

\*1:  $E = D_2 + 0.5 (D_2 < 5)$   
 $E = D_2 + 1 (D_2 \geq 5)$

\*2: In a case where the bore diameter is  $\phi 4$  or less, the set screw is used in only one place.

## Dimensions

Unit : mm

| Part Number | A  | L    | W  | F   | M  | Screw Tightening Torque (N·m) |
|-------------|----|------|----|-----|----|-------------------------------|
| XGS-15      | 15 | 6.5  | 18 | 3   | M3 | 0.7                           |
| XGS-19      | 19 | 7.7  | 20 | 4   | M3 | 0.7                           |
| XGS-25      | 25 | 9.5  | 27 | 5   | M4 | 1.7                           |
| XGS-27      | 27 | 9.5  | 27 | 5   | M4 | 1.7                           |
| XGS-30      | 30 | 11   | 30 | 5.5 | M4 | 1.7                           |
| XGS-34      | 34 | 12   | 35 | 6   | M5 | 4                             |
| XGS-39      | 39 | 15.5 | 40 | 8   | M5 | 4                             |

| Part Number | Standard Bore Diameter (Dimensional Allowance H8) |         |         |         |         |         |          |          |           |          |
|-------------|---|---------|---------|---------|---------|---------|----------|----------|-----------|----------|
|             | D1-D2   |         |         |         |         |         |          |          |           |          |
| XGS-15      | 3 - 5   | 3 - 6   | 4 - 4   | 4 - 5   | 4 - 6   | 4.5 - 5 | 5 - 5    | 5 - 6    | 6 - 6     |          |
| XGS-19      | 4 - 5   | 5 - 5   | 5 - 6   | 5 - 7   | 5 - 8   | 6 - 6   | 6 - 6.35 | 6 - 7    | 6 - 8     | 6.35 - 8 |
| XGS-25      | 5 - 6   | 5 - 8   | 6 - 6   | 6 - 8   | 6 - 10  | 6 - 11  | 6 - 12   | 6.35 - 8 | 6.35 - 10 | 8 - 8    |
| XGS-27      | 5 - 6   | 5 - 8   | 5 - 14  | 6 - 6   | 6 - 8   | 6 - 10  | 6 - 11   | 6 - 12   | 6 - 14    | 8 - 8    |
| XGS-30      | 8 - 8   | 8 - 10  | 8 - 11  | 8 - 12  | 8 - 14  | 8 - 15  | 10 - 10  | 10 - 11  | 10 - 12   | 10 - 14  |
| XGS-34      | 8 - 8   | 8 - 10  | 8 - 11  | 8 - 12  | 8 - 14  | 8 - 15  | 10 - 10  | 10 - 11  | 10 - 12   | 10 - 14  |
| XGS-39      | 10 - 10   | 10 - 12 | 10 - 14 | 10 - 15 | 10 - 16 | 12 - 12 | 12 - 14  | 12 - 15  | 12 - 16   | 12 - 19  |
|             | 12 - 20   | 14 - 14 | 14 - 15 | 14 - 16 | 15 - 15 | 15 - 16 | 15 - 19  | 16 - 16  | 17 - 17   | 20 - 20  |

- All products are provided with hex socket set screws.
- Recommended tolerance for shaft diameters is h6 and h7.

## Performance

| Part Number | Max. Bore Diameter (mm) | Keyway Additional Modification Max. Bore Diameter (mm) | Rated *1 Torque (N·m) | Max. Rotational Frequency (min <sup>-1</sup> ) | Moment*2 of Inertia (kg·m <sup>2</sup> ) | Static Torsional Stiffness (N·m/rad) | Max. Lateral Misalignment (mm) | Max. Angular Misalignment (°) | Max. Axial Misalignment (mm) | Mass *2 (g) |
|-------------|-------------------------|--|-----------------------|--|--|--------------------------------------|--------------------------------|-------------------------------|------------------------------|-------------|
| XGS-15      | 6                       | —  | 0.5                   | 42000  | $2.2 \times 10^{-7}$                     | 25                                   | 0.15                           | 1.5                           | ±0.2                         | 7           |
| XGS-19      | 8                       | 6  | 0.8                   | 33000  | $6.3 \times 10^{-7}$                     | 63                                   | 0.15                           | 1.5                           | ±0.2                         | 12          |
| XGS-25      | 12                      | 9  | 2.3                   | 25000  | $2.4 \times 10^{-6}$                     | 100                                  | 0.15                           | 1.5                           | ±0.2                         | 26          |
| XGS-27      | 14                      | 10   | 2.3                   | 23000  | $3.2 \times 10^{-6}$                     | 120                                  | 0.15                           | 1.5                           | ±0.2                         | 29          |
| XGS-30      | 15                      | 11   | 3.3                   | 21000  | $5.6 \times 10^{-6}$                     | 160                                  | 0.2                            | 1.5                           | ±0.3                         | 41          |
| XGS-34      | 16                      | 12   | 5.5                   | 18000  | $1.1 \times 10^{-5}$                     | 350                                  | 0.2                            | 1.5                           | ±0.3                         | 62          |
| XGS-39      | 20                      | 15   | 7                     | 16000  | $2.2 \times 10^{-5}$                     | 440                                  | 0.2                            | 1.5                           | ±0.3                         | 91          |

\*1: Correction of rated torque due to load fluctuation is not required. If ambient temperature exceeds 30°C, be sure to correct the rated torque with temperature correction factor shown in the following table.

The allowable operating temperature of XGS is -20°C to 80°C.

\* The shaft's slip torque may be smaller than the coupling's rated torque depending on the shaft bore. → P.xxxx

\*2: These are values with max. bore diameter.

### • Ambient Temperature / Temperature Correction Factor

| Ambient Temperature | Temperature Correction Factor |
|---------------------|-------------------------------|
| -20°C to 30°C       | 1.00                          |
| 30°C to 40°C        | 0.80                          |
| 40°C to 60°C        | 0.70                          |
| 60°C to 80°C        | 0.55                          |

### • Part number specification

**XGS-34-11-12**



[Additional Keyway at Shaft Hole → P.xxxx](#)
[Cleanroom Wash & Packaging → P.xxxx](#)
[Change to Stainless Steel Screw → P.xxxx](#)