

XGT Flexible Couplings - High - gain Rubber Type - Set Screw Type Specification Change

[WEB Selection Tool](#)
[WEB CAD Download](#)
[Zero Backlash](#)
[High gain supported](#)
[High torque](#)
[Vibration absorption](#)

XGT

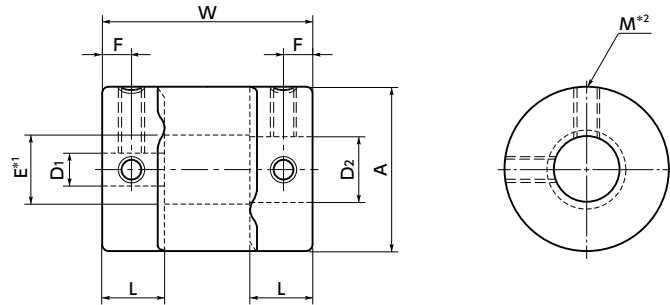

*1: $E = D_2 + 0.5 (D_2 < 5)$
 $E = D_2 + 1 (D_2 \geq 5)$

*2: In a case where the bore diameter is $\phi 4$ or less, the set screw is used in only one place.

Dimensions

Unit : mm

| Part Number | A | L | W | F | M | Screw Tightening Torque (N·m) |
|-------------|----|------|----|-----|----|-------------------------------|
| XGT-15 | 15 | 6.5 | 23 | 3 | M3 | 0.7 |
| XGT-19 | 19 | 7.7 | 26 | 4 | M3 | 0.7 |
| XGT-25 | 25 | 9.5 | 32 | 5 | M4 | 1.7 |
| XGT-27 | 27 | 9.5 | 32 | 5 | M4 | 1.7 |
| XGT-30 | 30 | 11 | 36 | 5.5 | M4 | 1.7 |
| XGT-34 | 34 | 12 | 38 | 6 | M5 | 4 |
| XGT-39 | 39 | 15.5 | 48 | 8 | M5 | 4 |
| XGT-44 | 44 | 15 | 48 | 7.5 | M6 | 7 |
| XGT-56 | 56 | 19.5 | 60 | 10 | M6 | 7 |

| Part Number | Standard Bore Diameter (Dimensional Allowance H8) | | | | | | | | | |
|-------------|---|--------------------|--------------------|--------------------|--------------------|--------------------|--------------------|--------------------|--------------------|--------------------|
| | D1-D2 | | | | | | | | | |
| XGT-15 | 3 - 5 | 3 - 6 | 4 - 4 | 4 - 5 | 4 - 6 | 4.5 - 5 | 5 - 5 | 5 - 6 | 6 - 6 | |
| XGT-19 | 4 - 5 6.35 - 8 | 4 - 8 8 - 8 | 5 - 5 | 5 - 6 | 5 - 7 | 5 - 8 | 6 - 6 | 6 - 6.35 | 6 - 7 | 6 - 8 |
| XGT-25 | 5 - 6 8 - 10 | 5 - 8 8 - 11 | 6 - 6 8 - 12 | 6 - 8 10 - 10 | 6 - 10 10 - 12 | 6 - 11 12 - 12 | 6 - 12 | 6.35 - 8 | 6.35 - 10 | 8 - 8 |
| XGT-27 | 5 - 6 8 - 10 | 5 - 8 8 - 11 | 5 - 14 8 - 12 | 6 - 6 8 - 14 | 6 - 8 10 - 10 | 6 - 10 10 - 12 | 6 - 11 10 - 14 | 6 - 12 12 - 12 | 6 - 14 12 - 14 | 8 - 8 14 - 14 |
| XGT-30 | 8 - 8 10 - 15 | 8 - 10 11 - 12 | 8 - 11 12 - 12 | 8 - 12 12 - 14 | 8 - 14 12 - 15 | 8 - 15 14 - 14 | 10 - 10 14 - 15 | 10 - 11 15 - 15 | 10 - 12 | 10 - 14 |
| XGT-34 | 8 - 8 10 - 15 | 8 - 10 11 - 11 | 8 - 11 11 - 12 | 8 - 12 12 - 12 | 8 - 14 12 - 14 | 8 - 15 12 - 15 | 10 - 10 14 - 14 | 10 - 11 14 - 15 | 10 - 12 15 - 15 | 10 - 14 16 - 16 |
| XGT-39 | 10 - 10 12 - 20 | 10 - 12 14 - 14 | 10 - 14 14 - 15 | 10 - 15 14 - 16 | 10 - 16 15 - 15 | 12 - 12 15 - 16 | 12 - 14 15 - 19 | 12 - 15 16 - 16 | 12 - 16 17 - 17 | 12 - 19 20 - 20 |
| XGT-44 | 12 - 12 15 - 19 | 12 - 14 15 - 20 | 12 - 16 16 - 16 | 12 - 19 16 - 19 | 14 - 14 17 - 17 | 14 - 15 19 - 20 | 14 - 16 20 - 20 | 14 - 19 | 15 - 15 | 15 - 16 |
| XGT-56 | 15 - 15 | 15 - 19 | 15 - 20 | 15 - 25 | 19 - 20 | 19 - 24 | 20 - 20 | 20 - 25 | 24 - 25 | 25 - 25 |

- All products are provided with hex socket set screws.
- Recommended tolerance for shaft diameters is h6 and h7.

Performance

| Part Number | Max. Bore Diameter (mm) | Keyway Additional Modification Max. Bore Diameter (mm) | Rated *1 Torque (N·m) | Max. Rotational Frequency (min ⁻¹) | Moment*2 of Inertia (kg·m ²) | Static Torsional Stiffness (N·m/rad) | Max. Lateral Misalignment (mm) | Max. Angular Misalignment (°) | Max. Axial Misalignment (mm) | Mass *2 (g) |
|-------------|-------------------------|--|-----------------------|--|--|--------------------------------------|--------------------------------|-------------------------------|------------------------------|-------------|
| XGT-15 | 6 | - | 1.1 | 42000 | 2.6×10^{-7} | 43 | 0.15 | 1.5 | ±0.2 | 9 |
| XGT-19 | 8 | 6 | 2.1 | 33000 | 7.5×10^{-7} | 88 | 0.15 | 1.5 | ±0.2 | 15 |
| XGT-25 | 12 | 9 | 4 | 25000 | 2.7×10^{-6} | 140 | 0.15 | 1.5 | ±0.2 | 29 |
| XGT-27 | 14 | 10 | 4 | 23000 | 3.6×10^{-6} | 140 | 0.15 | 1.5 | ±0.2 | 32 |
| XGT-30 | 15 | 11 | 6.3 | 21000 | 6.3×10^{-6} | 220 | 0.2 | 1.5 | ±0.3 | 46 |
| XGT-34 | 16 | 12 | 8 | 18000 | 1.1×10^{-5} | 390 | 0.2 | 1.5 | ±0.3 | 66 |
| XGT-39 | 20 | 15 | 13.5 | 16000 | 2.4×10^{-5} | 520 | 0.2 | 1.5 | ±0.3 | 103 |
| XGT-44 | 22 | 17 | 18 | 14000 | 4.0×10^{-5} | 640 | 0.2 | 1.5 | ±0.3 | 133 |
| XGT-56 | 28 | 22 | 35 | 11000 | 1.3×10^{-4} | 1500 | 0.2 | 1.5 | ±0.3 | 267 |

*1: Correction of rated torque due to load fluctuation is not required. If ambient temperature exceeds 30°C, be sure to correct the rated torque with temperature correction factor shown in the following table.

The allowable operating temperature of XGT is -20°C to 80°C.

※ The shaft's slip torque may be smaller than the coupling's rated torque depending on the shaft bore. → P.xxxx

*2: These are values with max. bore diameter.

• Ambient Temperature / Temperature Correction Factor

| Ambient Temperature | Temperature Correction Factor |
|---------------------|-------------------------------|
| -20°C to 30°C | 1.00 |
| 30°C to 40°C | 0.80 |
| 40°C to 60°C | 0.70 |
| 60°C to 80°C | 0.55 |

• Part number specification

XGT-39 - 12-20

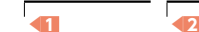

[Additional Keyway at Shaft Hole → P.xxxx](#)
[Cleanroom Wash & Packaging → P.xxxx](#)
[Change to Stainless Steel Screw → P.xxxx](#)

Available / Add'l charge Please combine with Stainless Steel Screw Alteration Service Available / Add'l charge