

SET-TZB (INCH) / SETS (INCH) Hexalobular Socket Head Cap Screw with Extra Low Profile (Inch Thread) NEW

[WEB Selection Tool](#)
[WEB CAD Download](#)
[SUS Stainless steel](#)
[Protrusion](#)

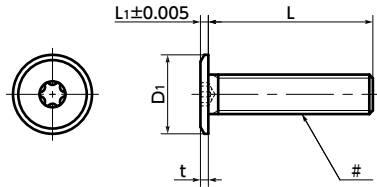

● Material/Finish

RoHS2 Compliant

	SET-TZB (INCH)	SETS (INCH)
Main Body	Steel Trivalent Chromate Treatment	SUSXM7 (Equivalent to SUS304)

- Hexalobular socket *1 head cap screw with extra low profile.
- All head heights are 1 mm (0.04 in) or less.
- For space-saving of equipment/devices and applications with limited overhead space.
- Hexalobular socket shapes*1 are designed to withstand high tightening torque. → P.xxxx
- Install and remove with **SKX** Dedicated Wrench or **SKXB** Dedicated Bit and **SRD** Dedicated Magnetic Screwdriver together.
- Use the **SKX-N** hexalobular wrench for extremely limited access spaces for mounting and removing in tight spaces.
- We manufacture products with special specifications such as ventilation holes, nylon patches, cleanroom washing and special packaging. → P.xxxx



*1: The hexalobular shape is prescribed by JIS B 1015: 2008(ISO 10664: 2005)"Hexalobular internal driving feature for bolts and screws".

● Application

Reducing the size of equipment and devices
Equipment and devices using inch screw specifications

SET-TZB (INCH) Made of Steel

Unit : inch

Part Number	# Nominal of Thread	L	D1	L1	Applicable Wrench	Hexalobular Socket No.	t	Max. Torque (N·m)	Mass (g)
SET-#6-32-TZB	No.6-32UNC	1 / 4 3 / 8 1 / 2	3 / 4	0.295	0.034	SKX-6	6	0.029 0.95	0.48 - 1.2
SET-#8-32-TZB	No.8-32UNC	1 / 4 3 / 8 1 / 2	3 / 4	0.315	0.036	SKX-8	8	0.035 2.3	0.78 - 1.9
SET-#10-24-TZB	No.10-24UNC	1 / 2 5 / 8 3 / 4	3 / 4	0.335	0.038	SKX-8	8	0.035 2.4	1.6 - 2.3
SET-#10-32-TZB	No.10-32UNF	1 / 2 5 / 8 3 / 4	3 / 4	0.335	0.038	SKX-8	8	0.035 2.4	1.7 - 2.4

Part Number	Qty per pack
SET-#6-32-TZB	10
SET-#8-32-TZB	10
SET-#10-24-TZB	10
SET-#10-32-TZB	10

● Also sold separately from 1 piece up. → P.xxxx

[Individual Sales](#) → P.xxxx
 [Cleanroom Wash & Packaging](#) → P.xxxx
 [Screw Length Adjustment](#) → P.xxxx
 [Vibration Resistant](#) → P.xxxx
 [Modification process for captive use](#) → P.xxxx
 Available / Add'l charge Available / Add'l charge Available / Add'l charge Available / Add'l charge Please feel free to contact us

● Related Products

Metric thread type, steel with nickel plating **SET-NI** is available.
→ P.xxxx



Metric thread type, steel with black nickel plating **SET-BNI** is available.
→ P.xxxx



Metric thread type, stainless steel **SETS** is available.
→ P.xxxx



SKX Hexalobular Wrench
→ P.xxxx



SKX-N Hexalobular Wrench for Extremely Limited Access Spaces
→ P.xxxx



SKXB Hexalobular Short Bit
→ P.xxxx



SRD Magnet Screwdriver
→ P.xxxx



● Part number specification

SET-#6-32-1/4-TZB



Order in number of packs.
Also sold separately from 1 piece up. → P.xxxx

SETS (INCH) Made of Stainless Steel

Unit : inch

Part Number	# Nominal of Thread	L	D1	L1	Applicable Wrench	Hexalobular Socket No.	t	Max. Torque (N·m)	Mass (g)
SETS-#4-40	No.4-40UNC	1 / 4 5 / 16 3 / 8	0.236	0.024	SKX-5	5	0.019	0.5	0.3 - 0.42
SETS-#6-32	No.6-32UNC	1 / 4 3 / 8 1 / 2	0.295	0.034	SKX-6	6	0.029	0.95	0.48 - 1.2
SETS-#8-32	No.8-32UNC	1 / 4 3 / 8 1 / 2	0.315	0.036	SKX-8	8	0.035	2.3	0.78 - 1.9
SETS-#10-24	No.10-24UNC	1 / 2 5 / 8 3 / 4	0.335	0.038	SKX-8	8	0.035	2.4	1.6 - 2.3
SETS-#10-32	No.10-32UNF	1 / 2 5 / 8 3 / 4	0.335	0.038	SKX-8	8	0.035	2.4	1.7 - 2.4

Part Number	Qty per pack
SETS-#4-40	10
SETS-#6-32	10
SETS-#8-32	10
SETS-#10-24	10
SETS-#10-32	10

● Also sold separately from 1 piece up. → P.xxxx