

# SFB/SFBS Socket Button Head Cap Screws with Flange

WEB Selection Tool | WEB CAD Download | SUS Stainless steel | Protrusion

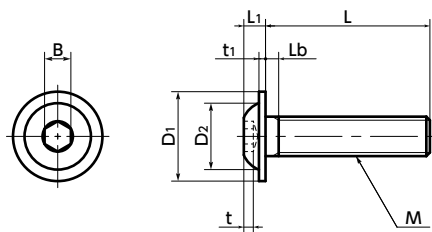

- Socket button head cap screws with wide bearing surface and are resistant to looseness.
- Intended for reducing the size of devices and applications with limited overhead space.
- Compared to **SFB** (Ferrosferic Oxide Coating), **SFB-EL** (Electroless nickel plating) has excellent corrosion resistance.

● Application

Reducing the size of equipment and devices

● Material/Finish

	SFB	SFBS	SFB-EL
Main Body	SCM435 Ferrosferic Oxide Coating (Black)	SUSXM7 (Equivalent to SUS304)	SCM435 Electroless nickel plating
Strength Class	10.9	A2-50	10.9



**SFB** Steel - Ferrosferic Oxide Coating

Part Number <sup>1</sup>	M (Coarse)		L <sup>2</sup>	D1	D2	L1	t1	B	t	Lb	Max. Torque (N·m)	Mass (g)
	Nominal of Thread	Pitch										
<b>SFB-M3</b>	M3	0.5	6 8 10 12	7	5.2	1.65	0.6	2	1.05	1	1	0.52 - 0.78
<b>SFB-M4</b>	M4	0.7	6 8 10 12 16 20	9.2	6.8	2.2	0.7	2.5	1.3	1.4	2	1 - 2
<b>SFB-M5</b>	M5	0.8	8 10 12 16 20 25	11.4	8.5	2.75	0.9	3	1.6	1.6	4	2 - 4
<b>SFB-M6</b>	M6	1	8 10 12 16 20 25	13.6	10.1	3.3	1	4	2.1	2	8	3 - 5.9
<b>SFB-M8</b>	M8	1.25	10 12 16 20 25 17	12.6	4.4	1.4	5	2.6	2.5	12	6.8 - 11	

Part Number	Qty*1 per pack
<b>SFB-M3</b>	50
<b>SFB-M4</b>	50
<b>SFB-M5</b>	20
<b>SFB-M6</b>	20
<b>SFB-M8</b>	20

\*1: Also sold separately from 1 piece up. → P.xxxx

**SFBS** Made of Stainless Steel

Part Number <sup>1</sup>	M (Coarse)		L <sup>2</sup>	D1	D2	L1	t1	B	t	Lb	Max. Torque (N·m)	Mass (g)
	Nominal of Thread	Pitch										
<b>SFBS-M3</b>	M3	0.5	6 8 10 12	7	5.2	1.65	0.6	2	1.05	1	0.25	0.52 - 0.78
<b>SFBS-M4</b>	M4	0.7	6 8 10 12 16 20	9.2	6.8	2.2	0.7	2.5	1.3	1.4	0.5	1 - 2
<b>SFBS-M5</b>	M5	0.8	8 10 12 16 20 25	11.4	8.5	2.75	0.9	3	1.6	1.6	1	2 - 4
<b>SFBS-M6</b>	M6	1	8 10 12 16 20	13.6	10.1	3.3	1	4	2.1	2	2	3 - 5.2

Part Number	Qty*1 per pack
<b>SFBS-M3</b>	20
<b>SFBS-M4</b>	20
<b>SFBS-M5</b>	20
<b>SFBS-M6</b>	20

\*1: Also sold separately from 1 piece up. → P.xxxx

**SFB-EL** Steel - Electroless nickel plating

Part Number <sup>1</sup>	M (Coarse)		L <sup>2</sup>	D1	D2	L1	t1	B	t	Lb	Max. Torque (N·m)	Mass (g)
	Nominal of Thread	Pitch										
<b>SFB-M3-EL</b>	M3	0.5	6 8 10 12	7	5.2	1.65	0.6	2	1.05	1	1	0.52 - 0.78
<b>SFB-M4-EL</b>	M4	0.7	6 8 10 12 16 20	9.2	6.8	2.2	0.7	2.5	1.3	1.4	2	1 - 2
<b>SFB-M5-EL</b>	M5	0.8	8 10 12 16 20 25	11.4	8.5	2.75	0.9	3	1.6	1.6	4	2 - 4
<b>SFB-M6-EL</b>	M6	1	8 10 12 16 20 25	13.6	10.1	3.3	1	4	2.1	2	8	3 - 5.9
<b>SFB-M8-EL</b>	M8	1.25	10 12 16 20 25 17	12.6	4.4	1.4	5	2.6	2.5	12	6.8 - 11	

Part Number	Qty*1 per pack
<b>SFB-M3-EL</b>	20
<b>SFB-M4-EL</b>	20
<b>SFB-M5-EL</b>	20
<b>SFB-M6-EL</b>	20
<b>SFB-M8-EL</b>	20

\*1: Also sold separately from 1 piece up. → P.xxxx

● Part number specification

**SFB-M5-20-EL**  
<sup>1</sup> <sup>2</sup> <sup>1</sup>

Select "L", and then Order in number of packs.  
 Also sold separately from 1 piece up. → P.xxxx

Individual Sales → P.xxxx | Cleanroom Wash & Packaging → P.xxxx | Screw Length Adjustment → P.xxxx | Vibration Resistant → P.xxxx | Modification process for captive use → P.xxxx  
 Available / Add'l charge | Please feel free to contact us | Available / Add'l charge | Available / Add'l charge | Please feel free to contact us