

SPS-LH Plastic Screws - Hexalobular Socket Head Cap Screws with Low Profile - PPS

Protrusion Heat-resistance Chemical-proof High Specific Strength

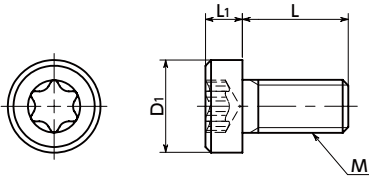

Material/Finish



	SPS-LH
Main Body	PPS (Polyphenylene Sulfide) (Bright Light Brown) (Glass Fiber 40%)
Heat Resistance Temperature*1	200°C

*1 : This is the value for the resin material. The operating temperature of the product changes with performance conditions such as tightening torque.

Application

FPD production equipment / Semiconductor devices / Printed circuit board etching devices /
Metallic surface treatment equipment and facilities / Chemical plants / Transformers /
Electrical and electronic equipment / Hot water pumps / Chemical pumps

- PPS low profile cap screw.
- PPS has excellent heat resistance and chemical resistance plus continuous use at 200°C. There are no fats or organic solvents capable of attacking PPS below 200°C.
- Retains high strength, rigidity and heat resistance.
- It also has high flame retardance which clears the UL 94 V-0 standard.
- The recess has a hexalobular*1 shape that can withstand high tightening torque.
- Install and remove with **SKX** Dedicated Wrench or **SKXB** Dedicated Bit and **SRD** Dedicated Magnetic Screwdriver together.
- Use the **SKX-N** hexalobular wrench for extremely limited access spaces for mounting and removing in tight spaces.
- For the properties and precautions of plastic screws, please refer to "Properties of Plastic Screws".

*1 : The hexalobular shape is prescribed by JIS B 1015: 2008(ISO 10664: 2005)"Hexalobular internal driving feature for bolts and screws".

Part Number	M (Coarse)		L								D1	L1	Applicable Wrench	Hexalobular Socket No.	Tension Rupture Load*1 (N)	Torsional Torque*1 (N·m)	Mass (g)	per Pack Qty
	Nominal of Thread	Pitch	6	8	10	12	16	20	25	30								
SPS-M3-LH	M3	0.5	6	8	10	12	16	20			5.5	2.4	SKX-10	10	566	0.28	0.14 - 0.26	10
SPS-M4-LH	M4	0.7	6	8	10	12	16	20	25		7	3.1	SKX-20	20	918	0.71	0.25 - 0.54	10
SPS-M5-LH	M5	0.8	8	10	12	16	20	25	30		8.5	3.65	SKX-25	25	1584	1.4	0.49 - 1.04	10
SPS-M6-LH	M6	1		10	12	16	20	25	30	40	10	4.4	SKX-30	30	2011	1.86	0.81 - 1.9	10

*1 : Values in chart are for reference only. They are not guaranteed values. The recommended tightening torque is 50% of the torsional torque.

When purchasing less volume than one full bag, a separate handling fee is charged. For details, see the Sold Separately Service.

Individual Sales	Cleanroom Wash & Packaging	Screw Length Adjustment	Vibration Resistant	Modification process for captive use
Available / Add'l charge	Available / Add'l charge	Available / Add'l charge	Not Available	Available / Add'l charge

Related Products

PPS hex nuts and washers
SPS-N **SPS-W** are available.



SKX Hexalobular Wrench



SKX-N Hexalobular Wrench for Extremely Limited Access Spaces



SKXB Hexalobular Short Bit



SRD Magnet Screwdriver



Part number specification

SPS - M5 - 30 - LH

Product Symbol 1 2 Product Symbol