

SSHT Hex Socket Head Cap Screws with Special Low Profile - Pure Titanium

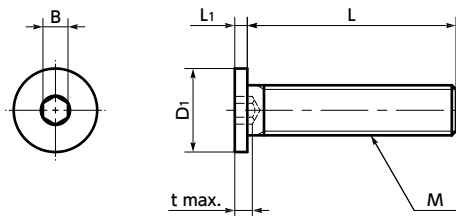

 Protrusion  Chemical-proof



- Socket head cap screws with special low profile made of pure titanium.
- The head height for all screws is 1.5 mm or less.
- Specific gravity is approximately 60% of stainless steel.
- Useful for space and weight saving of devices.
- Nonmagnetic.
- Excellent chemical and seawater resistance.
- Chemical polishing and brightening processing improve the screw surface. Furthermore, the screws are cleanroom washed, cleanroom packed, and comply with clean specifications that require no oil or foreign matter deposits.
- About the features of titanium

• Application

Lightweight applications in automobiles, aircrafts, spacecrafts, and robots.

Reducing the size of equipment and devices.



FPD production equipment, semiconductor devices, electrical and electronic equipment, aquatic applications, and electrochemical plating

• Material/Finish



SSHT	
Main Body	TW340(Grade2 Titanium)

Unit : mm

Part Number 	M (Coarse)		L 					D1	L1	B	t	Max. Torque* (N·m)	Mass (g)
	Nominal of Thread	Pitch	6	8	10	12							
SSHT-M3	M3	0.5	6	8	10		6	1.3	1.5	2	0.6	0.25 - 0.35	
SSHT-M4	M4	0.7		8	10	12	8	1.5	2	2.5	1.2	0.59 - 0.76	
SSHT-M5	M5	0.8			10	12	16	9	1.5	3	2.5	0.7 - 1.12	
SSHT-M6	M6	1			10	12	16	10	1.5	3	4	1.1 - 1.7	



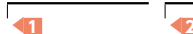

* : Values in chart are for reference only. They are not guaranteed values.

• Part number specification

SSHT-M3-10



Batch cleanroom packing is provided for orders containing multiple items of the same size.

 Individual Sales	 Cleanroom Wash & Packaging	 Screw Length Adjustment	 Vibration Resistant	 Modification process for captive use
1 piece in 1 pack	Cleanroom washed and packed	Available / Add'l charge	Available / Add'l charge	Available / Add'l charge