

SLH-SD/SLHS-SD Socket Head Cap Screws with Low & Small Head

WEB Selection Tool CAD Download SUS Stainless steel Protrusion Small Head

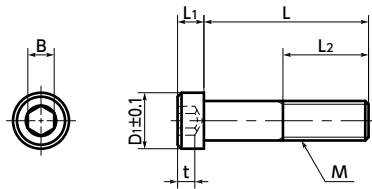

⚠ Precautions for Use

- Since the head bearing surface area is small, bearing surface pressure become high.
- Using the following formula as a reference, ensure that the bearing surface pressure due to screw tightening does not exceed the permitted surface pressure of the intended fastening material.

$$P = \sigma \frac{A_s}{A}$$

P: Bearing surface pressure (N/mm²)
 σ: Bolt stress (N/mm²)
 A_s: Screw effective sectional area (mm²)
 A: Bearing surface area (mm²)

Bearing surface area $A = \pi \frac{(D_1^2 - d^2)}{4}$

D₁: Head diameter (mm)
 d: Drilled hole diameter (mm)

● Head Diameter and Screw Effective Cross-sectional Area

Part Number	Head Diameter (mm)	Screw effective cross-sectional area (mm ²)
SLH-M3-SD	4.5	5.03
SLH-M4-SD	5.5	8.78
SLH-M5-SD	7	14.2
SLH-M6-SD	8.5	20.1
SLH-M8-SD	11	36.6
SLH-M10-SD	13.5	58

SLH-SD Steel - Ferrosferic Oxide Coating

Part Number	M	2	L	3								D1	L1	B	t	L2*1	Mass (g)
SLH-M3-SD	M3	6	8	10	12						4.5	2	2	1.5	Full Thread	0.5 - 0.7	
SLH-M4-SD	M4	6	8	10	12	16	20	25			5.5	2.8	2.5	2.3	Full Thread	0.9 - 2.4	
SLH-M5-SD	M5		8	10	12	16	20	25			7	3	3	2.2	Full Thread	1.7 - 3.8	
SLH-M6-SD	M6		8	10	12	16	20	25	30		8.5	3.5	4	2.5	18(L=30)	2.6 - 6.5	
SLH-M8-SD	M8			10	12	16	20	25	30	35	11	4.5	5	3.3	22(L=35)	5.9 - 14	
SLH-M10-SD	M10					16	20	25	30	35	40	13.5	5.5	6	4	Full Thread	13 - 25

*1: If the "L" value is not in parentheses, the screw is full thread.

Part Number	Qty per pack*1
SLH-M3-SD	10
SLH-M4-SD	10
SLH-M5-SD	10
SLH-M6-SD	10
SLH-M8-SD	10
SLH-M10-SD	10

*1: Also sold separately from 1 piece up. ➔ P.xxxx

Individual Sales ➔ P.xxxx Cleanroom Wash & Packaging ➔ P.xxxx Screw Length Adjustment ➔ P.xxxx Vibration Resistant ➔ P.xxxx Modification process for captive use ➔ P.xxxx Available / Add'l charge Please feel free to contact us Available / Add'l charge Available / Add'l charge Please feel free to contact us



- Socket head cap screws with low profiles and small head diameters. Able to reduce the spot facing diameters compared to standard socket head cap screws with low profiles.

● Application

Reducing the size of equipment and devices

● Material/Finish

	SLH-SD	SLH-SD-EL	SLHS-SD
Main Body	SWCH45K Ferrosferic Oxide Film (Black)	SWCH45K Electroless Nickel Plating	SUSXM7 (Equivalent to SUS304)
Strength Class	8.8	8.8	A2-50

RoHS2 Compliant

● Usage example

It is possible to perform spot facing and hide the head in locations where spot facing is not possible with standard socket head cap screws.

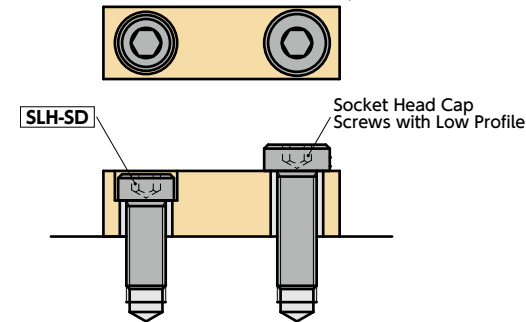

● Part number specification

SLH-M5-20-SD-EL

1 2 3 4

Order in number of packs.

Also sold separately from 1 piece up. ➔ P.xxxx

SLH-SD-EL Steel - Electroless Nickel Plating

Part Number	M	2	L	3								D1	L1	B	t	L2*1	Mass (g)
SLH-M3-SD-EL	M3	6	8	10	12							4.5	2	2	1.5	Full Thread	0.5 - 0.7
SLH-M4-SD-EL	M4	6	8	10	12	16	20	25				5.5	2.8	2.5	2.3	Full Thread	0.9 - 2.4
SLH-M5-SD-EL	M5		8	10	12	16	20	25				7	3	3	2.2	Full Thread	1.7 - 3.8
SLH-M6-SD-EL	M6		8	10	12	16	20	25	30			8.5	3.5	4	2.5	18(L=30)	2.6 - 6.5
SLH-M8-SD-EL	M8			10	12	16	20	25	30	35		11	4.5	5	3.3	22(L=35)	5.9 - 14
SLH-M10-SD-EL	M10					16	20	25	30	35	40	13.5	5.5	6	4	Full Thread	13 - 25

*1: If the "L" value is not in parentheses, the screw is full thread.

Part Number	Qty per pack*1
SLH-M3-SD-EL	10
SLH-M4-SD-EL	10
SLH-M5-SD-EL	10
SLH-M6-SD-EL	10
SLH-M8-SD-EL	10
SLH-M10-SD-EL	10

*1: Also sold separately from 1 piece up. ➔ P.xxxx

SLHS-SD Stainless Steel

Part Number	M	2	L	3							D1	L1	B	t	L2*1	Mass (g)	
SLHS-M3-SD	M3	6	8	10	12						4.5	2	2	1.5	Full Thread	0.5 - 0.7	
SLHS-M4-SD	M4	6	8	10	12	16	20	25			5.5	2.8	2.5	2.3	Full Thread	0.9 - 2.4	
SLHS-M5-SD	M5		8	10	12	16	20	25			7	3	3	2.2	Full Thread	1.7 - 3.8	
SLHS-M6-SD	M6		8	10	12	16	20	25	30		8.5	3.5	4	2.5	18(L=30)	2.6 - 6.5	
SLHS-M8-SD	M8			10	12	16	20	25	30	35	11	4.5	5	3.3	22(L=35)	5.9 - 14	
SLHS-M10-SD	M10					16	20	25	30	35	40	13.5	5.5	6	4	Full Thread	13 - 25

*1: If the "L" value is not in parentheses, the screw is full thread.

Part Number	Qty per pack*1
SLHS-M3-SD	10
SLHS-M4-SD	10
SLHS-M5-SD	10
SLHS-M6-SD	10
SLHS-M8-SD	10
SLHS-M10-SD	10

*1: Also sold separately from 1 piece up. ➔ P.xxxx