

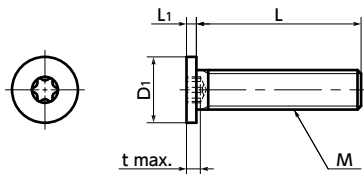

SSTS Hexalobular Socket Head Cap Screws with Special Low Profile

SUS Stainless steel Protrusion



● Application

Reducing the size of equipment and devices

● Material/Finish



	SSTS
Main Body	SUSXM7 (Equivalent to SUS304)
Strength Class	A2-50

● Part number specification

SSTS-M5-12



- All head heights are 1.5mm or less.
- For space-saving of equipment/devices and applications with limited overhead space.
- Hexalobular socket shapes*1 are designed to withstand high tightening torque. → P.xxxx
- Install and remove with **SKX** Dedicated Wrench or **SKXB** Dedicated Bit and **SRD** Dedicated Magnetic Screwdriver together.
- Use the **SKX-N** hexalobular wrench for extremely limited access spaces for mounting and removing in tight spaces.

*1 : The hexalobular shape is prescribed by JIS B 1015: 2008(ISO 10664: 2005)"Hexalobular internal driving feature for bolts and screws".

Unit : mm

Part Number 1	M (Coarse)		L 2								D1	L1	Applicable wrench	Hexalobular Socket No.	t	Max. Torque (N·m)	Mass (g)	Qty per pack	
	Nominal of Thread	Pitch																	
SSTS-M2	M2	0.4	4	5	6	8					4	1.2	SKX-5	5	0.9	0.18	0.11 - 0.19	10	
SSTS-M2.5	M2.5	0.45	4	5	6	8					5	1.3	SKX-6	6	1	0.36	0.23 - 0.35	10	
SSTS-M3	M3	0.5		5	6	8	10				6	1.3	SKX-8	8	1.1	0.65	0.4 - 0.61	10	
SSTS-M4	M4	0.7			6	8	10	12			8	1.5	SKX-10	10	1.5	1.5	0.89 - 1.3	10	
SSTS-M5	M5	0.8			6	8	10	12	16		9	1.5	SKX-15	15	1.8	3.1	0.73 - 2	10	
SSTS-M6	M6	1				8	10	12	16	20	10	1.5	SKX-20	20	2.1	5.3	1.6 - 3.8	10	
SSTS-M8	M8	1.25					8	10	12	16	20	13	1.5	SKX-25	25	2.4	12	3 - 6.7	10

● When purchasing less volume than one full bag, a separate handling fee is charged. For details, see the Sold Separately Service.

● Related Products

SKX Hexalobular Wrench



SKXB Hexalobular Short Bit



SKX-N Hexalobular Wrench for Extremely Limited Access Spaces



SRD Magnet Screwdriver



Individual Sales → P.xxxxx	Cleanroom Wash & Packaging → P.xxxxx	Screw Length Adjustment → P.xxxxx	Vibration Resistant → P.xxxxx	Modification process for captive use → P.xxxxx
Available / Add'l charge	Available / Add'l charge	Available / Add'l charge	Available / Add'l charge	Available / Add'l charge