

# MOR Flexible Coupling - Oldham - type - Set Screw type Additional Size

[WEB Selection Tool](#)
[WEB CAD Download](#)
[High torque](#)
[Electrical Insulation](#)
[High Allowable Misalignment](#)
[Small Eccentric Reaction Force](#)

MOR

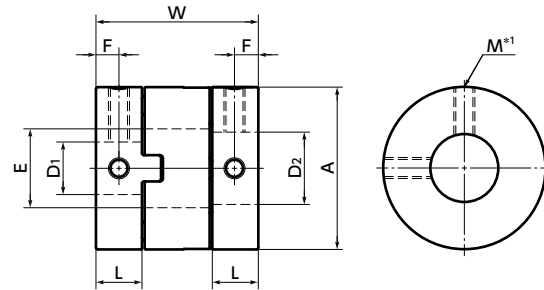

\*1: In a case where the bore diameter is  $\phi 4$  or less, the set screw is used in only one place.

## Dimensions

Unit : mm

Part Number	A	L	W	E	F	M	Screw Tightening Torque (N·m)
MOR-6	6	2.5	8.4	2.1	1.3	M2	0.3
MOR-8	8	2.5	9.6	3.1	1.3	M2	0.3
MOR-10	10	2.9	10.4	4.1	1.4	M2	0.3
MOR-12	12	3.9	14.4	5.2	2	M3	0.7
MOR-15	15	4.4	16	8.2	2.2	M3	0.7
MOR-17	17	4.9	19.7	8.2	2.5	M3	0.7
MOR-20	20	5.8	21.6	12.2	2.9	M4	1.7
MOR-26	26	7.3	25.6	14.2	3.7	M4	1.7
MOR-30	30	10	32.6	16.2	5	M4	1.7
MOR-34	34	11.1	34	16.2	5.6	M5	4
MOR-38	38	12.1	40.1	20.3	6.1	M5	4
MOR-45	45	13.8	46	22.3	6.9	M6	7
MOR-55	55	18.7	57	26.5	9.4	M8	15
MOR-68	68	24	77	38.5	12	M10	30

Unit : mm

Part Number	Standard Metric Bore Diameter (dimensional allowance H8)																							
	D1 · D2																							
	1	1.5	2	3	4	5	6	6.35	8	9.525	10	12	14	15	16	18	20	22	25	28	30	35	38	
MOR-6	●	●	●																					
MOR-8	●		●	●																				
MOR-10			●	●	●																			
MOR-12				●	●	●																		
MOR-15					●	●	●	●	●															
MOR-17					●	●	●	●	●															
MOR-20					●	●	●	●	●	●	●	●												
MOR-26						●	●	●	●	●	●	●	●	●										
MOR-30								●	●	●	●	●	●	●	●	●								
MOR-34											●	●	●	●	●	●	●							
MOR-38												●	●	●	●	●	●	●	●					
MOR-45													●	●	●	●	●	●	●	●	●			
MOR-55														●	●	●	●	●	●	●	●	●		
MOR-68																●	●	●	●	●	●	●	●	●

Unit : inch

Part Number	Standard Inch Bore Diameter (dimensional allowance H8)						
	D1 · D2						
	1 / 4	5 / 16	3 / 8	1 / 2	5 / 8	3 / 4	7 / 8
MOR-15	●	●					
MOR-17	●	●					
MOR-20	●	●	●				
MOR-26	●	●	●	●			
MOR-30			●	●	●		
MOR-34			●	●	●		
MOR-38			●	●	●	●	
MOR-45				●	●	●	
MOR-55					●	●	●

- All products are provided with hex socket set screws.
- Recommended tolerance for shaft diameters is h6 and h7.
- A set of hubs with set screw type for one side and clamping type for the other side and others are available upon request.

- Part number specification

**MOR-15 - 5-6** 1 Set



**MOR-20 - SPCR** Single Spacer

Product Code    Outside Diameter (A Dimension)    Single Spacer

[Additional Keyway at Shaft Hole](#) → P. xxxx   
 [Cleanroom Wash & Packaging](#) → P. xxxx   
 [Change to Stainless Steel Screw](#) → P. xxxx  
 Available / Add'l charge    Please feel free to contact us    Available / Add'l charge

# MOR Flexible Coupling - Oldham - type - Set Screw type Additional Size

WEB Selection Tool

WEB CAD Download



High torque



Electrical Insulation



High Allowable Misalignment



Small Eccentric Reaction Force

## Performance

Part Number	Max. Bore Diameter (mm)	Rated Torque *1 (N·m)	Maximum Torque *1 (N·m)	Max. Rotational Frequency (min <sup>-1</sup> )	Moment of *2 Inertia (kg·m <sup>2</sup> )	Static Torsional Stiffness (N·m/rad)	Max. Lateral Misalignment (mm)	Max. Angular Misalignment (°)	Mass *2 (g)
MOR-6	2	0.2	0.4	100000	$2.2 \times 10^{-9}$	5	0.5	3	0.4
MOR-8	3	0.5	1	78000	$7.4 \times 10^{-9}$	12	0.7	3	0.8
MOR-10	4	0.8	1.6	63000	$1.9 \times 10^{-8}$	23	0.9	3	1
MOR-12	5	1	2	52000	$5.3 \times 10^{-8}$	60	1	3	3
MOR-15	8	1.6	3.2	42000	$1.4 \times 10^{-7}$	80	1	3	4
MOR-17	8	2.2	4.4	37000	$2.8 \times 10^{-7}$	120	1.2	3	7
MOR-20	12	3.2	6.4	31000	$5.7 \times 10^{-7}$	120	1.2	3	9
MOR-26	14	6	12	24000	$2.1 \times 10^{-6}$	300	1.5	3	20
MOR-30	16	15	30	21000	$5.4 \times 10^{-6}$	530	2	3	38
MOR-34	16	16	32	18000	$9.1 \times 10^{-6}$	1000	2.5	3	52
MOR-38	20	28	56	16000	$1.6 \times 10^{-5}$	1500	2.5	3	69
MOR-45	22	30	60	14000	$3.3 \times 10^{-5}$	2400	3	3	110
MOR-55	26	45	90	11000	$1.0 \times 10^{-4}$	4100	4	3	230
MOR-68	38	80	160	9000	$3.7 \times 10^{-4}$	6400	4.5	3	430

\*1: Values with no load fluctuation and rotation in a single direction. If there is large load fluctuation, or both normal and reverse rotation, select a size with some margin. If ambient temperature exceeds 30°C, be sure to correct the rated torque and max. torque with temperature correction factor shown in the following table. The allowable operating temperature of **MOR** is -20°C to 80°C.

\*2: These are values with max. bore diameter.

### ● Comparison of rated torque

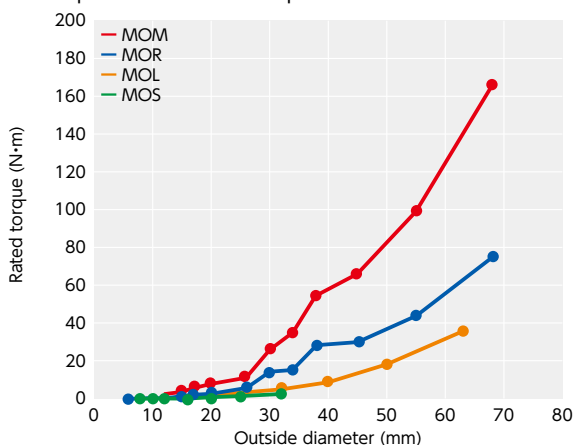

### ● Ambient Temperature / Temperature Correction Factor

Ambient Temperature	Temperature Correction Factor
-20°C to 30°C	1.00
30°C to 40°C	0.80
40°C to 60°C	0.70
60°C to 80°C	0.55