

# SPA-LC Plastic screw - Hex Socket Low Head Bolt - RENY Additional Size

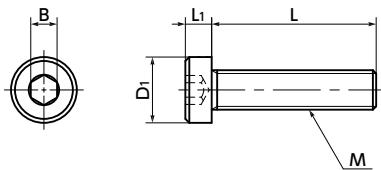

WEB Selection Tool    WEB CAD Download    High strength



● Material/Finish

RoHS2 Compliant

	<b>SPA-LC</b>
Main body	RENY*1 (Glass Fiber 50% Reinforced Polyamide MXD6) (Black)
Heat resistance temperature*2	105°C

- \*1: RENY is a registered trademark of Mitsubishi Engineering-Plastics Corporation.
- \*2: A value of plastic materials. The allowable operating temperature of the product varies depending on use conditions such as tightening torque.

- Hex socket head cap screw with low head.
- For space-saving of equipment/device and applications with a limited top space.
- RENY is thermoplastic engineering plastics with excellent tensile strength and bending strength.
- It is highly fatigue-resistant and has excellent creeping and heat insulation properties.
- While it is nearly as strong as metal, its weight is approximately 1/5 of iron.
- The properties and precautions of plastic screws  
➔ P.xxxx

● Application

Heat insulation and dew condensation prevention of electric and electronic devices / refrigerating and freezing facilities / Weight saving of offshore instruments, plating facility and automobile, aircraft and space equipment, etc.

Unit : mm

Part Number	M (Coarse)		L <span style="color:red">②</span>												D1	L1	B	Tension*1 Rupture Load (N)	Torsional*1 Torque (N·m)	Mass (g)
	Nominal of Thread <span style="color:red">①</span>	Pitch	6	8	10	12	16	20	25	30	35	40	45	50						
<b>SPA-M3-LC</b>	M3	0.5	6	8	10	12	16	20							5.5	2	2	799	0.2	0.11 - 0.25
<b>SPA-M4-LC</b>	M4	0.7	6	8	10	12	16	20	25						7	2.8	2.5	1286	0.74	0.24 - 0.58
<b>SPA-M5-LC</b>	M5	0.8	6	8	10	12	16	20	25	30					8.5	3.5	3	1976	1.08	0.39 - 1
<b>SPA-M6-LC</b>	M6	1			10	12	16	20	25	30	40				10	4	4	2767	2.26	0.75 - 2.1

\*1: Values in chart are for reference only. They are not guaranteed values. The recommendation torque is 50% of the torsional torque.

Part Number	Qty per pack*1
<b>SPA-M3-LC</b>	20
<b>SPA-M4-LC</b>	20
<b>SPA-M5-LC</b>	20
<b>SPA-M6-LC</b>	20

\*1: Also sold separately from 1 piece up. ➔ P.xxxx

● Part number specification

## SPA - M5 - 30 - LC

Product Code ① ② Product Code

Order in number of packs.

Also sold separately from 1 piece up. ➔ P.xxxx

Individual Sales ➔ P.xxxx	Cleanroom Wash & Packaging ➔ P.xxxx	Screw Length Adjustment ➔ P.xxxx	Vibration Resistant ➔ P.xxxx	Modification process for captive use ➔ P.xxxx
Available / Add'l charge	Available / Add'l charge	Not Available	Not Available	Not Available