

SPC-C Plastic Screws - Hex Socket Head Cap Screws - PC NEW

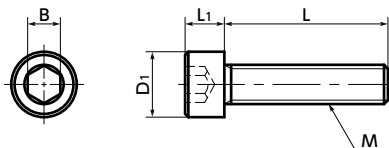

WEB Selection Tool WEB CAD Download



● Material/Finish

RoHS2 Compliant

	SPC-C
Main Body	PC (Polycarbonate) (Transparent)
Heat Resistance Temperature*1	115°C

*1: This is the value for the resin material. The operating temperature of the product changes with performance conditions such as tightening torque.

- PC (polycarbonate) has the highest shock resistance of engineering plastics.
- Max. Operating Temperature*1(min./max.): -40/115°C
- PC has low water absorbency and excellent weather resistance.
- The properties and precautions of plastic screws
➔ P.xxxx

● Application

Electrical and electronic equipment and automobiles

Part Number	M (Coarse)		L 2								D1	L1	B	Tension Rupture Load*1 (N)	Torsional Torque*1 (N·m)	Mass (g)		
	Nominal of Thread 1	Pitch	6	8	10	12	15	20	25	30							35	40
SPC-M3-C	M3	0.5	6	8	10	12	15	20	25				5.5	3	2.5	266	0.18	0.11 - 0.25
SPC-M4-C	M4	0.7	6	8	10	12	15	20	25				7	4	3	481	0.39	0.23 - 0.48
SPC-M5-C	M5	0.8			10	12	15	20	25	30	35		8.5	5	4	797	0.8	0.42 - 0.97
SPC-M6-C	M6	1			10	15	20	25	30	35	40		10	6	5	1136	1.2	0.72 - 1.7
SPC-M8-C	M8	1.25			10	15	20	25	30	35	40		13	8	6	2088	3.2	1.6 - 3.3

Unit : mm

*1: Values in chart are for reference only. They are not guaranteed values. The recommended tightening torque is 50% of the torsional torque.

Part Number	Qty*1 per Pack
SPC-M3-C	20
SPC-M4-C	20
SPC-M5-C	20
SPC-M6-C	20
SPC-M8-C	20

*1: Also sold separately from 1 piece up. ➔ P.xxxx

● Part number specification

SPC-M5-20-C

Product Code 1 2 Product Code

Order in number of packs.

Also sold separately from 1 piece up. ➔ P.xxxx

Individual Sales ➔ P.xxxx	Cleanroom Wash & Packaging ➔ P.xxxx	Screw Length Adjustment ➔ P.xxxx	Vibration Resistant ➔ P.xxxx	Modification process for captive use ➔ P.xxxx
Available / Add'l charge	Available / Add'l charge	Available / Add'l charge	Not Available	Please feel free to contact us