

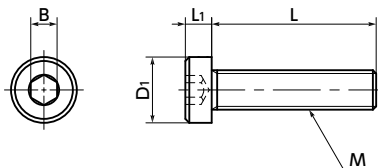

SPE-LC Plastic screw - Hex Socket Low Head Bolt - PEEK

[WEB Selection Tool](#)
 [WEB CAD Download](#)
 [Chemical-proof](#)



● Application

FPD production device / Semiconductor manufacturing device / Print board etching equipment / Metal surface treatment facility / Chemical plant / Transformer / Electric and electronic device / Hydrothermal pump / Chemical pump

● Material/Finish

RoHS2 Compliant

	SPE-LC
Main body	PEEK / Light Brown
Heat resistance temperature*1	260°C

*1: A value of plastic materials. The allowable operating temperature of the product varies depending on use conditions such as tightening torque.

⚠ Precautions for Use

Because a cumulative pitch difference is created when PEEK screws are manufactured, use these screws with nuts. If a nut is not used, use a 20 mm or less fit with female thread.

- Hex socket head cap screw with low head.
- For space-saving of equipment/device and applications with a limited top space.
- PEEK is thermoplastic super engineering plastic superior in physical and chemical properties.
- Excellent chemical resistance. It resists almost all chemicals other than concentrated sulfuric acid, concentrated nitric acid and concentrated hydrofluoric acid.
- It is highly heat-resistant and water-proofed and high temperature strength is retained.
- Features outstanding friction, shock, and fatigue resistance.
- It is highly frame-resistant satisfying V-0 of the UL standard 94.
- Plastic screw properties and precautions for use
➔ P.xxxx

Unit : mm

Part Number	M (Coarse)		L											D1	L1	B	Tension*1 Rupture Load (N)	Torsional*1 Torque (N·m)	Mass (g)				
	Nominal of Thread	Pitch																					
SPE-M3-LC	M3	0.5	6	8	10	12	16	20										5.5	2	2	400	0.13	0.09 - 0.2
SPE-M4-LC	M4	0.7	6	8	10	12	16	20	25									7	2.8	2.5	744	0.47	0.19 - 0.46
SPE-M5-LC	M5	0.8	6	8	10	12	16	20	25	30								8.5	3.5	3	1272	0.68	0.26 - 0.81
SPE-M6-LC	M6	1			10	12	16	20	25	30	40							10	4	4	1727	1.36	0.58 - 1.6

*1: Values in chart are for reference only. They are not guaranteed values. The recommendation torque is 50% of the torsional torque.

Part Number	Qty per pack*1
SPE-M3-LC	10
SPE-M4-LC	10
SPE-M5-LC	10
SPE-M6-LC	5

*1: Also sold separately from 1 piece up. ➔ P.xxxx

● Related Products

PEEK hexagon nuts **SPE-N** are available.

➔ P.xxxx



● Part number specification

SPE-M5-30-LC

Product Code Product Code

Order in number of packs.

Also sold separately from 1 piece up. ➔ P.xxxx

Individual Sales ➔ P.xxxx	Cleanroom Wash & Packaging ➔ P.xxxx	Screw Length Adjustment ➔ P.xxxx	Vibration Resistant ➔ P.xxxx	Modification process for captive use ➔ P.xxxx
Available / Add'l charge	Available / Add'l charge	Available / Add'l charge	Not Available	Please feel free to contact us