

MLR-C/MLRS-C Rigid Couplings - Clamping Type

Zero Backlash High Rigidity SUS Stainless steel

MLR-C Made of aluminum alloy
MLRS-C Made of all stainless steel

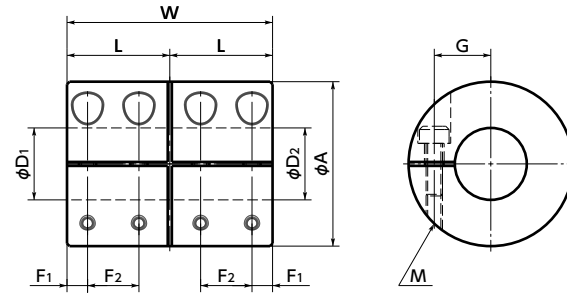

Dimensions

Unit : mm

| Part Number | A | L | W | F1 | F2 | G | M | Screw Tightening Torque (N·m) | Standard Bore Diameter | | | | | | | |
|-----------------|----|----|----|-----|-----|----|------|-------------------------------|------------------------|---------|---------|---------|---------|---------|---------|--|
| | | | | | | | | | D1-D2 | | | | | | | |
| MLR-16C | 16 | 11 | 22 | 2.5 | 5.5 | 5 | M2 | 0.5 | 5 - 5 | 5 - 6 | 6 - 6 | | | | | |
| MLR-20C | 20 | 12 | 24 | 2.5 | 6 | 7 | M2 | 0.5 | 6 - 6 | 6 - 8 | 8 - 8 | | | | | |
| MLR-25C | 25 | 18 | 36 | 4.5 | 9 | 9 | M2.5 | 1 | 8 - 8 | 8 - 10 | 10 - 10 | 12 - 12 | | | | |
| MLR-32C | 32 | 20 | 40 | 4 | 10 | 11 | M3 | 1.5 | 10 - 10 | 10 - 12 | 10 - 14 | 12 - 12 | 12 - 14 | 14 - 14 | 15 - 15 | |
| MLRS-16C | 16 | 11 | 22 | 2.5 | 5.5 | 5 | M2 | 0.5 | 5 - 5 | 5 - 6 | 6 - 6 | | | | | |
| MLRS-20C | 20 | 12 | 24 | 2.5 | 6 | 7 | M2 | 0.5 | 6 - 6 | 6 - 8 | 8 - 8 | | | | | |
| MLRS-25C | 25 | 18 | 36 | 4.5 | 9 | 9 | M2.5 | 1 | 8 - 8 | 8 - 10 | 10 - 10 | 12 - 12 | | | | |
| MLRS-32C | 32 | 20 | 40 | 4 | 10 | 11 | M3 | 1.5 | 10 - 10 | 10 - 12 | 10 - 14 | 12 - 12 | 12 - 14 | 14 - 14 | 15 - 15 | |

- All products are provided with hex socket head cap screw.
- Recommended tolerance for shaft diameters is h6 and h7.
- In case of mounting on D-cut shaft, be careful about the position of the D-cut surface of the shaft.
- For the shaft insertion amount to the coupling, see Mounting/maintenance.

Performance

| Part Number | Max. Bore Diameter (mm) | Rated Torque *1 (N·m) | Max. Rotational Frequency (min ⁻¹) | Moment of Inertia *2 (kg·m ²) | Mass *2 (g) |
|-----------------|-------------------------|-----------------------|--|---|-------------|
| MLR-16C | 6 | 1 | 39000 | 3.4×10 ⁻⁷ | 10 |
| MLR-20C | 8 | 2.5 | 31000 | 9.2×10 ⁻⁷ | 18 |
| MLR-25C | 12 | 4.5 | 25000 | 3.4×10 ⁻⁶ | 38 |
| MLR-32C | 15 | 10 | 19000 | 1.0×10 ⁻⁵ | 70 |
| MLRS-16C | 6 | 0.3 | 39000 | 8.9×10 ⁻⁷ | 25 |
| MLRS-20C | 8 | 0.5 | 31000 | 2.5×10 ⁻⁶ | 45 |
| MLRS-25C | 12 | 1 | 25000 | 9.2×10 ⁻⁶ | 100 |
| MLRS-32C | 15 | 2 | 19000 | 2.7×10 ⁻⁵ | 180 |

- *1 : Correction of rated torque due to load fluctuation is not required.
- *2 : These are values with max. bore diameter.

• Part number specification

MLR-16C-5-5



Additional Keyway at Shaft Hole → P.xxxx Cleanroom Wash & Packaging → P.xxxx Change to Stainless Steel Screw → P.xxxx
 Available / Add'l charge Please feel free to contact us Please feel free to contact us