

# MRG/MRGS Rigid Couplings - Set Screw Type

Zero Backlash High torque High Rigidity SUS Stainless steel

**MRG** Made of aluminum alloy  
**MRGS** Made of all stainless steel

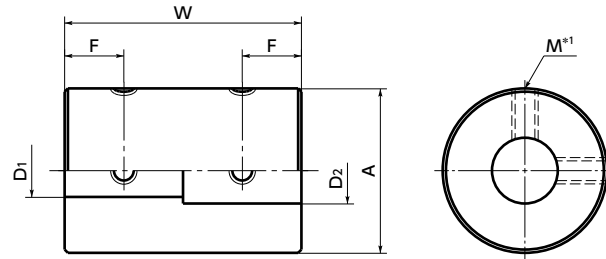

\*1: In a case where the bore diameter is φ 4 or less, the set screw is used in only one place.

## Dimensions • Performance

Unit : mm

Part Number	A	W	F	M	Screw Tightening Torque (N·m)	Standard Bore Diameter (dimensional allowance H8)																				
						D1 • D2		3	4	5	6	8	10	12	15	16	18	19	20	25	28	30	32			
<b>MRG-16</b>	16	24	6	M3	0.7	●	●	●	●																	
<b>MRG-20</b>	20	30	7	M3	0.7			●	●	●																
<b>MRG-25</b>	25	36	9	M4	1.7				●	●	●															
<b>MRG-32</b>	32	41	10	M4	1.7						●	●	●													
<b>MRG-40</b>	40	44	10.5	M5	4							●	●	●												
<b>MRG-50</b>	50	53	12	M6	7									●	●	●										
<b>MRG-65</b>	65	65	16	M8	15															●	●	●				
<b>MRGS-16</b>	16	24	6	M3	0.7			●	●																	
<b>MRGS-20</b>	20	30	7	M3	0.7			●	●	●																
<b>MRGS-25</b>	25	36	9	M4	1.7				●	●	●															
<b>MRGS-32</b>	32	41	10	M4	1.7						●	●	●													
<b>MRGS-40</b>	40	44	10.5	M5	4							●	●	●												
<b>MRGS-50</b>	50	53	12	M6	7									●	●	●										
<b>MRGS-65</b>	65	65	16	M8	15																●	●	●			

- All products are provided with hex socket set screws.
- Recommended tolerance for shaft diameters is h6 and h7.
- For the shaft insertion amount to the coupling, see Mounting/maintenance.

## Performance

Part Number	Max. Bore Diameter (mm)	Rated Torque *1 (N·m)	Max. Rotational Frequency (min <sup>-1</sup> )	Moment of Inertia *2 (kg·m <sup>2</sup> )	Mass *2 (g)
<b>MRG-16</b>	8	1	39000	4.4×10 <sup>-7</sup>	11
<b>MRG-20</b>	10	2.5	31000	1.3×10 <sup>-6</sup>	20
<b>MRG-25</b>	12	4.5	25000	3.9×10 <sup>-6</sup>	39
<b>MRG-32</b>	16	10	19000	1.2×10 <sup>-5</sup>	71
<b>MRG-40</b>	20	20	15000	2.8×10 <sup>-5</sup>	114
<b>MRG-50</b>	25	25	12000	8.4×10 <sup>-5</sup>	215
<b>MRG-65</b>	32	35	9000	2.9×10 <sup>-4</sup>	450
<b>MRGS-16</b>	8	0.3	39000	1.2×10 <sup>-6</sup>	28
<b>MRGS-20</b>	10	0.5	31000	3.5×10 <sup>-6</sup>	54
<b>MRGS-25</b>	12	1	25000	1.0×10 <sup>-5</sup>	100
<b>MRGS-32</b>	16	2	19000	3.1×10 <sup>-5</sup>	190
<b>MRGS-40</b>	20	3	15000	8.1×10 <sup>-5</sup>	326
<b>MRGS-50</b>	25	4.5	12000	2.4×10 <sup>-4</sup>	658
<b>MRGS-65</b>	32	7	9000	8.4×10 <sup>-4</sup>	1290

- \*1: Correction of rated torque due to load fluctuation is not required.
- \*2: These are values with max. bore diameter.

Additional Keyway at Shaft Hole → P.0000    Cleanroom Wash & Packaging → P.0000    SUS Change to Stainless Steel Screw → P.0000  
 Available / Add'l charge    Please feel free to contact us    Please feel free to contact us

• Part number specification

**MRGS-40-18-20**

1 2