

# SADS-LC Screw Adaptor - Left-handed Threaded Type

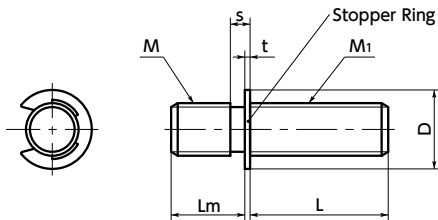

WEB Selection Tool    WEB CAD Download    SUS Stainless steel



- Usage example  
In combination with a clamp lever.

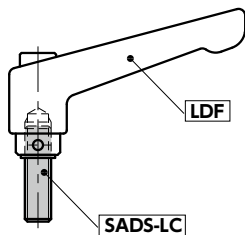

- By combining with female screw products such as a lever and knob, this may be used as a left-handed screw lever or knob.
- For screw fixing, use a pin stopper or anaerobic adhesive agent. If it is repeatedly tightened, a pin stopper is recommended.
- Use a stopper ring to accurately determine the threaded length.

- Material/Finish ✔ RoHS2 Compliant

	SADS-LC
Thread Part	SUS303
Stopper Ring	Equivalent to SUS304

## Dimensions

Unit : mm

Part Number	M (Right-hand screw) (Coarse)		M1 (Left-hand screw) (Coarse)		Lm	s	t	D	Mass (g)
	Nominal of Thread <span style="color: red;">◀1</span>	Pitch	Nominal of Thread	Pitch					
SADS-M4-LC	M4	0.7	M4	0.7	4.5	1.4	0.6	7	0.9 - 2.5
SADS-M5-LC	M5	0.8	M5	0.8	4.5	1.6	0.6	9	1.5 - 6.3
SADS-M6-LC	M6	1	M6	1	5.5	2	0.6	9	2.2 - 11
SADS-M8-LC	M8	1.25	M8	1.25	6.5	2.5	0.8	12	3.9 - 26
SADS-M10-LC	M10	1.5	M10	1.5	8.5	3	0.8	16	8.2 - 41

**SADS-LC** Made of Stainless Steel

Part Number	L (mm) <span style="color: red;">◀2</span>									
	12	16	20	25	32	40	50	63	80	
SADS-M4-LC	●	●	●	●	●					
SADS-M5-LC	●	●	●	●	●	●	●			
SADS-M6-LC	●	●	●	●	●	●	●	●		
SADS-M8-LC	●	●	●	●	●	●	●	●	●	
SADS-M10-LC		●	●	●	●	●	●	●	●	●

## ● Related Products

Screw adaptor with variable screw diameter **SADS-SD** are available.

➔ P.xxxx



- Part number specification

## SADS-M5-32-LC

Product Code ◀1 ◀2 Left Threaded Type

Cleanroom Wash & Packaging ➔ P.xxxx    Screw Combination ➔ P.xxxx    Screw Length Adjustment ➔ P.xxxx    Vibration Resistant ➔ P.xxxx

Available / Add'l charge

Available / Add'l charge

Available / Add'l charge

Available / Add'l charge