

SCB-R / SCBS-R Clamping Bolt - Full Ball *Recommendation*

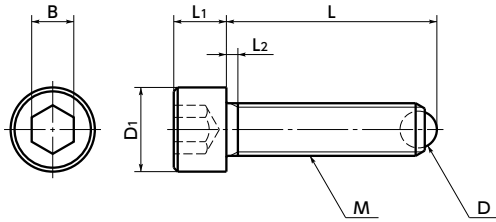

WEB Selection Tool WEB CAD Download SUS Stainless steel



● Material/Finish



	SCB-R Made of Steel	SCBS-R Made of Stainless Steel
Thread	SCM435	SUSXM7
Part	Ferrosferric Oxide Film (Black)	
Ball	SUJ2 (hardness: 55 - 60 HRC)	SUS440C (hardness: 55 - 60 HRC)

● Part number specification

SCBS-M6-20-R



- Point contact by full ball securely fixes a work.
- For tool holder set screw, pressure piece and stopper.
- We also produce products of special specifications, e.g. nominal diameter of thread, length and surface treatment. Please feel free to contact our customer service.

Unit : mm

Part Number Steel	Allowable load (N)	Part Number Stainless steel	Allowable load (N)	M (Coarse)		L	D ₁	D	L ₁	L ₂	B	Mass (g)
				Nominal of Thread	Pitch							
SCB-M4-10-R	3500	SCBS-M4-10-R	2040	M4	0.7	10.5	7	2.5	4	2.1	3	1.5
SCB-M4-12-R	3500	SCBS-M4-12-R	2040	M4	0.7	12.5	7	2.5	4	2.1	3	1.7
SCB-M4-16-R	3500	SCBS-M4-16-R	2040	M4	0.7	16.5	7	2.5	4	2.1	3	1.9
SCB-M4-20-R	3500	SCBS-M4-20-R	2040	M4	0.7	20.5	7	2.5	4	2.1	3	2.2
SCB-M4-25-R	3500	SCBS-M4-25-R	2040	M4	0.7	25.5	7	2.5	4	2.1	3	2.5
SCB-M5-12-R	5000	SCBS-M5-12-R	3000	M5	0.8	12.6	8.5	3	5	2.4	4	2.9
SCB-M5-16-R	5000	SCBS-M5-16-R	3000	M5	0.8	16.6	8.5	3	5	2.4	4	3.4
SCB-M5-20-R	5000	SCBS-M5-20-R	3000	M5	0.8	20.6	8.5	3	5	2.4	4	3.9
SCB-M5-25-R	5000	SCBS-M5-25-R	3000	M5	0.8	25.6	8.5	3	5	2.4	4	4.4
SCB-M5-30-R	5000	SCBS-M5-30-R	3000	M5	0.8	30.6	8.5	3	5	2.4	4	5
SCB-M6-16-R	9000	SCBS-M6-16-R	4500	M6	1	16.8	10	4	6	3	5	5.6
SCB-M6-20-R	9000	SCBS-M6-20-R	4500	M6	1	20.8	10	4	6	3	5	6.5
SCB-M6-25-R	9000	SCBS-M6-25-R	4500	M6	1	25.8	10	4	6	3	5	7.6
SCB-M6-30-R	9000	SCBS-M6-30-R	4500	M6	1	30.8	10	4	6	3	5	8.7
SCB-M6-40-R	9000	SCBS-M6-40-R	4500	M6	1	40.8	10	4	6	3	5	11
SCB-M8-20-R	15000	SCBS-M8-20-R	9000	M8	1.25	21.2	13	5.5	8	3.5	6	13.5
SCB-M8-30-R	15000	SCBS-M8-30-R	9000	M8	1.25	31.2	13	5.5	8	3.5	6	17.5
SCB-M8-35-R	15000	SCBS-M8-35-R	9000	M8	1.25	36.2	13	5.5	8	3.5	6	19
SCB-M8-40-R	15000	SCBS-M8-40-R	9000	M8	1.25	41.2	13	5.5	8	3.5	6	21.5
SCB-M8-50-R	15000	SCBS-M8-50-R	9000	M8	1.25	51.2	13	5.5	8	3.5	6	25
SCB-M10-25-R	24000	SCBS-M10-25-R	14400	M10	1.5	26.7	16	7	10	4.5	8	26
SCB-M10-30-R	24000	SCBS-M10-30-R	14400	M10	1.5	31.7	16	7	10	4.5	8	29
SCB-M10-40-R	24000	SCBS-M10-40-R	14400	M10	1.5	41.7	16	7	10	4.5	8	34
SCB-M10-50-R	24000	SCBS-M10-50-R	14400	M10	1.5	51.7	16	7	10	4.5	8	39
SCB-M10-60-R	24000	SCBS-M10-60-R	14400	M10	1.5	61.7	16	7	10	4.5	8	47
SCB-M12-30-R	30000	SCBS-M12-30-R	18000	M12	1.75	32	18	8.5	12	5	10	40
SCB-M12-50-R	30000	SCBS-M12-50-R	18000	M12	1.75	52	18	8.5	12	5	10	56
SCB-M12-80-R	30000	SCBS-M12-80-R	18000	M12	1.75	82	18	8.5	12	5	10	83
SCB-M16-40-R	73000	SCBS-M16-40-R	43800	M16	2	43.3	24	12	16	6	14	91
SCB-M16-60-R	73000	SCBS-M16-60-R	43800	M16	2	63.3	24	12	16	6	14	122
SCB-M16-80-R	73000	SCBS-M16-80-R	43800	M16	2	83.3	24	12	16	6	14	154

Cleanroom Wash & Packaging → P.0000	Screw Combination → P.0000	Screw Length Adjustment → P.0000	Vibration Resistant → P.0000
Please feel free to contact us	Not Available	Not Available	Available / Add'l charge