

SVSH-C22

Hex Socket Head Cap Screws (Hastelloy C - 22 equiv.) with Ventilation Hole

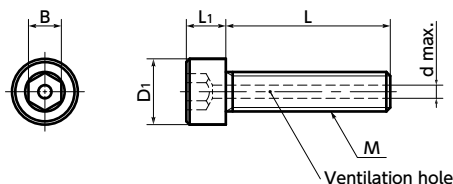

Vacuum
 Cleanroom wash & packaging
 Chemical-proof



● Material/Finish



	SVSH-C22
Main Body	UNS N06022 (Hastelloy*1C-22 equiv.)

*1: Hastelloy is a registered trademark of Haynes International, Inc.

● Mechanical property

	Hastelloy (UNS N06022)	SUS304
Tensile Strength (N/mm ²)	786	520 or More
0.2% Proof Load (N/mm ²)	365	205 or More
Elongation (%)	57	40 or More
Hardness (HRB)	92	90 or Less

● Values in chart are for reference only. They are not guaranteed values.

● Physical property

	Hastelloy (UNS N06022)	SUS304
Specific Gravity	8.61	7.93
Longitudinal Elastic Modulus (GPa)	209	193
Specific Heat (J/kg·K)	381	500
Electric Resistance ($\mu\Omega \cdot m$)	1.2	0.7
Linear Expansion Coefficient (K ⁻¹)	12.4×10^{-6}	17.3×10^{-6}

● Values in chart are for reference only. They are not guaranteed values.



● Hastelloy C-22 hex socket head cap screws

SVSH-C22 with ventilation hole.

- The ventilation hole easily releases gas trapped in the screw holes of equipment and machines, and supports vacuum drawing of vacuum devices.
- Hastelloy C-22 is one of the few metals which can withstand wet chlorine gas, hypochlorite, and chlorine dioxide.
- Excellent corrosion resistance against oxidizing and reducing acids and salts. ➔ P.xxxx
- Supports use with vacuum equipment in corrosive environments.
- Cleanroom wash/cleanroom packing provided. ➔ P.xxxx

● Application

Vacuum devices / Vacuum chambers / FPD production equipment / Semiconductor manufacturing equipment / Electron microscopes / Printed circuit board etching devices / Metallic surface treatment equipment and facilities / Chemical plants

Unit : mm

Part Number	M (Coarse)		L										D1	L1	B	d max.	Mass (g)
	Nominal of Thread	Pitch															
SVSH-M3-C22	M3	0.5	6	8	10	12	16	20					5.5	3	2.5	1.2	0.79 - 1.5
SVSH-M4-C22	M4	0.7		8	10	12	16	20	25				7	4	3	1.5	1.8 - 3.5
SVSH-M5-C22	M5	0.8			10	12	16	20	25				8.5	5	4	1.5	3 - 5.3
SVSH-M6-C22	M6	1				12	16	20	25	30			10	6	5	2	5.6 - 9.2
SVSH-M8-C22	M8	1.25					16	20	25	30	35		13	8	6	2	13 - 21

● Part number specification

SVSH-M5-16-C22

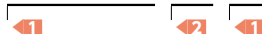

Batch cleanroom packing is provided for orders containing multiple items of the same size.

Individual Sales ➔ P.xxxx	Cleanroom Wash & Packaging ➔ P.xxxx	Screw Length Adjustment ➔ P.xxxx	Vibration Resistant ➔ P.xxxx	Modification process for captive use ➔ P.xxxx
1 piece in 1 pack	Cleanroom washed and packed	Available / Add'l charge	Not Available	Please feel free to contact us