

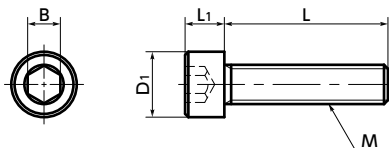

# SNSH-C22 Hex Socket Head Cap Screws (Hastelloy C - 22 equiv.)

WEB Selection Tool   
 WEB CAD Download   
 Cleanroom wash & packaging   
 Chemical-proof



## ● Mechanical property

	Hastelloy (UNS N06022)	SUS304
Tensile Strength (N/mm <sup>2</sup> )	786	520 or Higher
0.2% Proof Stress (N/mm <sup>2</sup> )	365	205 or Higher
Elongation (%)	57	40 or Higher
Hardness (HRB)	92	90 or Less

● Values in chart are for reference only. They are not guaranteed values.

## ● Physical property

	Hastelloy (UNS N06022)	SUS304
Specific Gravity	8.61	7.93
Longitudinal Elastic Modulus (GPa)	209	193
Specific Heat (J/kg·K)	381	500
Electric Resistance (μΩ·m)	1.2	0.7
Linear Expansion Coefficient (K <sup>-1</sup> )	12.4 x 10 <sup>-6</sup>	17.3 x 10 <sup>-6</sup>

● Values in chart are for reference only. They are not guaranteed values.

- Hastelloy C-22 is one of the few metals that is resistant to wet chlorine gas, hypochlorite, and chlorine dioxide.
- Excellent corrosion resistance against oxidizing and reducing acids and salts. ➔ P.xxxx
- For aquatic applications that use sea and salt water.
- Cleanroom wash and cleanroom packing are completed. ➔ P.xxxx

## ● Application

FPD production equipment, semiconductor devices, printed circuit board etching devices, metallic surface treatment equipment and facilities, and chemical plants

## ● Material/Finish

RoHS2 Compliant

SNSH-C22	
Main Body	UNS N06022(Hastelloy*1C-22 equiv.)

\*1 : Hastelloy is a registered trademark of Haynes International, Inc.

Unit : mm

Part Number	M (Coarse)		L								D1	L1	B	Tension*1 Rupture Load (N)	Mass (g)	
	Nominal of Thread	Pitch	6	8	10	12	16	20	25	30						35
<b>SNSH-M3-C22</b>	M3	0.5										5.5	3	2.5	3950	0.79 - 1.5
<b>SNSH-M4-C22</b>	M4	0.7										7	4	3	6900	1.8 - 3.5
<b>SNSH-M5-C22</b>	M5	0.8										8.5	5	4	11100	3 - 5.3
<b>SNSH-M6-C22</b>	M6	1										10	6	5	15700	5.6 - 9.2
<b>SNSH-M8-C22</b>	M8	1.25										13	8	6	28700	13 - 21

\*1 : Values in chart are for reference only. They are not guaranteed values.

Part Number	Qty per Pack
<b>SNSH-M3-C22</b>	1
<b>SNSH-M4-C22</b>	1
<b>SNSH-M5-C22</b>	1
<b>SNSH-M6-C22</b>	1
<b>SNSH-M8-C22</b>	1

## ● Part number specification

### SNSH - M5 - 16 - C22

Product Code			Product Code
--------------	--	--	--------------

Individual Sales ➔ P.xxxx	Cleanroom Wash & Packaging ➔ P.xxxx	Screw Length Adjustment ➔ P.xxxx	Vibration Resistant ➔ P.xxxx	Modification process for captive use ➔ P.xxxx
1 unit in 1 bag	Cleanroom washed and packed	Available / Add'l charge	Available / Add'l charge	Available / Add'l charge