

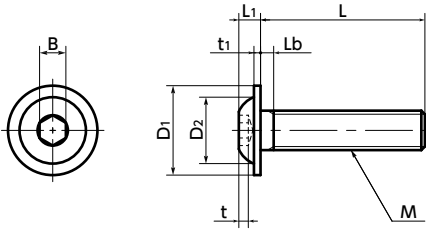

# SFB/SFBS Socket Button Head Cap Screws with Flange

SUS Stainless steel  Protrusion



● Part number specification

## SFB-M5-20-EL



- Socket button head cap screws with wide bearing surface and are resistant to looseness.
- Intended for reducing the size of devices and applications with limited overhead space.
- Compared to **SFB** (Ferrosoferric Oxide Coating), **SFB-EL** (Electroless nickel plating) has excellent corrosion resistance.

● Application

Reducing the size of equipment and devices

● Material/Finish



	SFB	SFBS	SFB-EL
Main Body	SCM435 Ferrosoferric Oxide Coating (Black)	SUSXM7 (Equivalent to SUS304)	SCM435 Electroless nickel plating
Strength Class	10.9	A2-50	10.9

**SFB** Steel - Ferrosoferric Oxide Coating

Unit : mm

Part Number	M (Coarse)		L	D1	D2	L1	t1	B	t	Lb	Max. Torque (N·m)	Mass (g)	Qty per pack
	Nominal of Thread	Pitch											
<b>SFB-M3</b>	M3	0.5	6 8 10 12	7	5.2	1.65	0.6	2	1.05	1	0.52 - 0.78	50	
<b>SFB-M4</b>	M4	0.7	6 8 10 12 16 20	9.2	6.8	2.2	0.7	2.5	1.3	1.4	1 - 2	50	
<b>SFB-M5</b>	M5	0.8	8 10 12 16 20 25	11.4	8.5	2.75	0.9	3	1.6	1.6	2 - 4	20	
<b>SFB-M6</b>	M6	1	8 10 12 16 20 25	13.6	10.1	3.3	1	4	2.1	2	3 - 5.9	20	
<b>SFB-M8</b>	M8	1.25	10 12 16 20 25	17	12.6	4.4	1.4	5	2.6	2.5	6.8 - 11	20	

● When purchasing less volume than one full bag, a separate handling fee is charged. For details, see the Sold Separately Service.

**SFBS** Made of Stainless Steel

Unit : mm

Part Number	M (Coarse)		L	D1	D2	L1	t1	B	t	Lb	Max. Torque (N·m)	Mass (g)	Qty per pack
	Nominal of Thread	Pitch											
<b>SFBS-M3</b>	M3	0.5	6 8 10 12	7	5.2	1.65	0.6	2	1.05	1	0.52 - 0.78	20	
<b>SFBS-M4</b>	M4	0.7	6 8 10 12 16 20	9.2	6.8	2.2	0.7	2.5	1.3	1.4	1 - 2	20	
<b>SFBS-M5</b>	M5	0.8	8 10 12 16 20 25	11.4	8.5	2.75	0.9	3	1.6	1.6	2 - 4	20	
<b>SFBS-M6</b>	M6	1	8 10 12 16 20 25	13.6	10.1	3.3	1	4	2.1	2	3 - 5.2	20	



● When purchasing less volume than one full bag, a separate handling fee is charged. For details, see the Sold Separately Service.

**SFB-EL** Steel - Electroless nickel plating

Unit : mm

Part Number	M (Coarse)		L	D1	D2	L1	t1	B	t	Lb	Max. Torque (N·m)	Mass (g)	Qty per pack
	Nominal of Thread	Pitch											
<b>SFB-M3-EL</b>	M3	0.5	6 8 10 12	7	5.2	1.65	0.6	2	1.05	1	0.52 - 0.78	20	
<b>SFB-M4-EL</b>	M4	0.7	6 8 10 12 16 20	9.2	6.8	2.2	0.7	2.5	1.3	1.4	1 - 2	20	
<b>SFB-M5-EL</b>	M5	0.8	8 10 12 16 20 25	11.4	8.5	2.75	0.9	3	1.6	1.6	2 - 4	20	
<b>SFB-M6-EL</b>	M6	1	8 10 12 16 20 25	13.6	10.1	3.3	1	4	2.1	2	3 - 5.9	20	
<b>SFB-M8-EL</b>	M8	1.25	10 12 16 20 25	17	12.6	4.4	1.4	5	2.6	2.5	6.8 - 11	20	

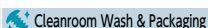
● When purchasing less volume than one full bag, a separate handling fee is charged. For details, see the Sold Separately Service.

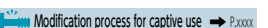
 Individual Sales → P.0000
  Cleanroom Wash & Packaging → P.0000
  Screw Length Adjustment → P.0000
  Vibration Resistant → P.0000
  Modification process for captive use → P.0000

Available / Add'l charge Please feel free to contact us Available / Add'l charge Available / Add'l charge Please feel free to contact us