

# SKCK Hexagon Sockets (with Screw Holding Function) **NEW**

WEB Selection Tool WEB CAD Download Easy operation

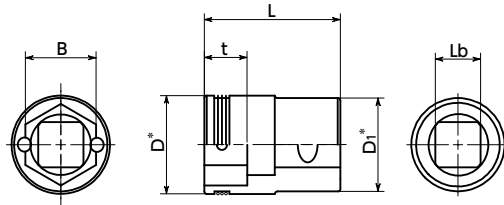

\* :  $D_1 < D (B \leq 12)$   
 $D_1 > D (B \geq 13)$

### Application

For narrow areas where screws cannot be retained by hand, during assembly/maintenance of devices, equipment, vehicles and so on  
 For preventing screws from falling into devices, such as food processing equipment where mechanical parts must be excluded, during maintenance

### Material/Finish

	<b>SKCK</b>
Main Body	SCM435
Wire Ring	Nickel Chrome Plating
Ball	SWPA
	SWCH



- A socket which holds hex head screws/bolts and hex nuts.
- The two balls pressed into the wire ring facing inwards hold hex head screws/bolts and hex nuts within the socket and prevent falling.

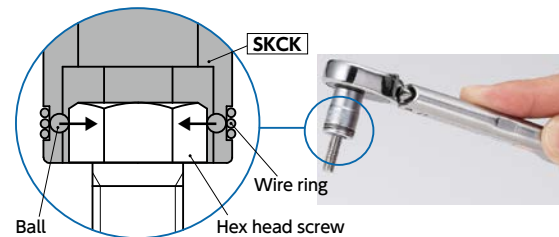

- Unlike magnetic holding methods, it can be used with hex head screws/bolts and hex nuts of any material. There is also no adherence of foreign matter due to socket magnetism.
- It can be used just like ordinary sockets.
- There are two types of insertion angle.  
**SKCK-\*\*-6.35** — Insertion angle 6.35  
**SKCK-\*\*-9.5** — Insertion angle 9.5

### SKCK-6.35 Insertion Angle 6.35

Part Number	B Nominal of Width Across Flats	Lb Insertion Angle	t	D	D <sub>1</sub>	L	Mass (g)	Qty per Pack
<b>SKCK-7-6.35</b>	7	6.35	4	11.3	11.2	18	8	1
<b>SKCK-8-6.35</b>	8	6.35	5	12.3	11.2	18	9	1

### SKCK-9.5 Insertion Angle 9.5

Part Number	B Nominal of Width Across Flats	Lb Insertion Angle	t	D	D <sub>1</sub>	L	Mass (g)	Qty per Pack
<b>SKCK-10-9.5</b>	10	9.5	6	14.5	17.3	26	24	1
<b>SKCK-12-9.5</b>	12	9.5	7	16.8	17.3	26	26	1
<b>SKCK-13-9.5</b>	13	9.5	8	18	17	26	28	1
<b>SKCK-14-9.5</b>	14	9.5	8.5	19.5	18.5	27	34	1
<b>SKCK-17-9.5</b>	17	9.5	9.5	23.3	21.5	28	62	1

### Usage example

For mounting and removal of screws in deep areas where hex head screws/bolts and hex nuts cannot be retained by hand.

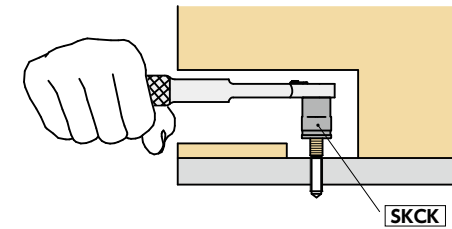

When mounting or removing hex head screws/bolts and hex nuts in narrow vertical areas, use a commercially available extension bar.

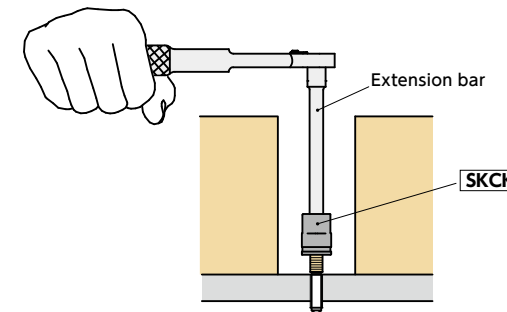

### Precautions for Use

- Use a size matching the nominal of width across flats.
- Retention may not be possible according to the dimensions and specifications of the hexagon.
- Insert firmly until hex head screws/bolts and hex nuts are retained.
- Do not use together with power tools like impact wrenches.
- Do not use in locations exposed to live wires, as it is made of metal.
- Do not use for any applications other than for turning screws.

### Part number specification

**SKCK-7-6.35**

