

SPEC-C Plastic Screw Conductive PEEK / Hex Socket Head Cap Screws

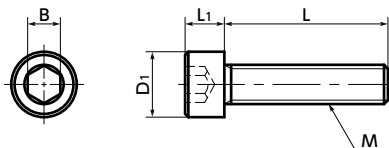

⚡ Electric conducting property 🧪 Chemical-proof



● Material/Finish



SPEC-C	
Main body	PEEK (Polyether ether ketone, carbon combined) (Black)
Heat resistance temperature*1	180°C

*1: A value of plastic materials. The allowable operating temperature of the product varies depending on use conditions such as tightening torque.

- Conductive PEEK hex socket head cap screw.
- For applications of preventing electrostatic charge due to contact and friction.
- Mechanical property, chemical resistance, heat resistance, waterproof, friction resistance, shock resistance and fatigue resistance equivalent to those of PEEK material.
- Plastic screw properties and precautions for use
→ P.xxxx

● Application

FPD production device / Semiconductor manufacturing device /
Print board etching equipment / Metal surface treatment facility /
Chemical plant / Transformer / Electric and electronic device

⚠ Precautions for Use

Because a cumulative pitch difference is created when PEEK screws are manufactured, use these screws with nuts. If a nut is not used, use a 20 mm or less fit with female thread.

Unit : mm

Part Number	M (Coarse) 1		L 2	D1	L1	B	Tension*1 Rupture Load (N)	Torsional*1 Torque (N·m)	Mass (g)
	Nominal of Thread	Pitch							
SPEC-M4-C	M4	0.7	10 12 15	7	4	3	600	0.35	0.31 - 0.39
SPEC-M5-C	M5	0.8	10 12 15 20	8.5	5	4	1160	0.96	0.46 - 0.69
SPEC-M6-C	M6	1	15 20 25	10	6	5	1590	1.62	0.99 - 1.3

*1: Values in chart are for reference only. They are not guaranteed values. The recommendation torque is 50% of the torsional torque.

● Part number specification

SPEC-M5-30-C

Product Code	1	2	Product Code
--------------	---	---	--------------

Individual Sales → P.xxxx	Cleanroom Wash & Packaging → P.xxxx	Screw Length Adjustment → P.xxxx	Vibration Resistant → P.xxxx	Modification process for captive use → P.xxxx
1 piece in 1 pack	Available / Add'l charge	Available / Add'l charge	Not Available	Please feel free to contact us