

MHW-C Flexible Couplings - Disk Type

WEB Selection Tool WEB CAD Download 0 Zero Backlash

Structure

● Clamping Type

MHW-C

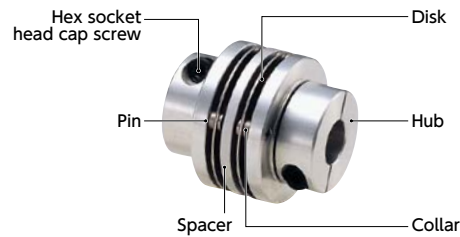

● Recommended Applicable Motor

	MHW-C
Servomotor	●
Stepping Motor	○
General-purpose Motor	●

○: Excellent ○: Very good ●: Available

● Property

	MHW-C
Zero Backlash	○
Allowable Misalignment	○

○: Excellent ○: Very good

- This is a disk type flexible coupling.
- The stainless steel disk allows eccentricity, and angular misalignment, and end-play.

● Application

XY stage / Transport device

● Material/Finish



	MHW-C
Hub	A2017 Anodized
Spacer	A2017 Anodized
Disk	SUS301
Pin	SUS303
Collar	SUS303
Hex Socket Head Cap Screw	SCM435 Ferrosferic Oxide Film (Black)

● Comparison of static torsional stiffness (Disk Type)

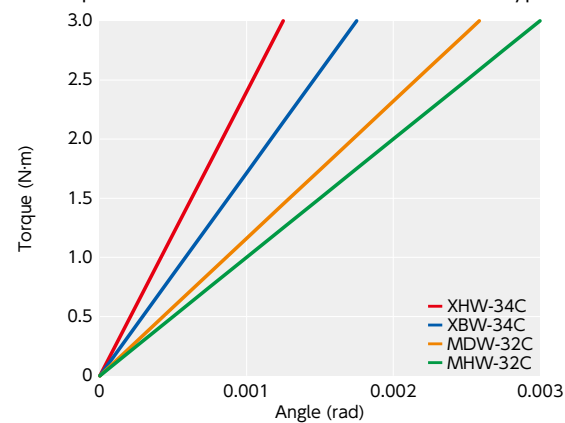

MHW-C

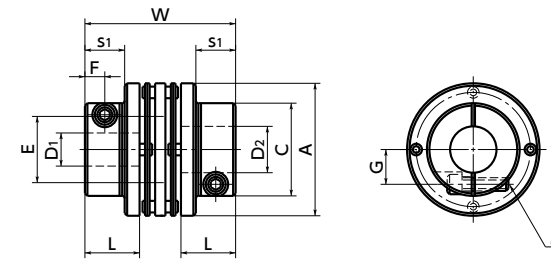

Dimensions

Unit : mm

Part Number	A	L	W	C	s1	E	F	G	M	Screw Tightening Torque (N·m)
MHW-32C	32	13.7	40	21.5	9	15	4	8	M3	1.5
MHW-40C	40	16.5	46	28	12	20	6	10.5	M4	2.5
MHW-50C	50	19.4	52	39	15	25	7	14.75	M5	7
MHW-63C	63	22.3	58	45	18	32	8	17	M6	12

Part Number	Standard Bore Diameter												
	D1/D2	6	8	10	11	12	14	15	16	18	19	20	25
MHW-32C	●	●	●										
MHW-40C		●	●	●	●	●							
MHW-50C					●	●	●	●	●	●	●	●	
MHW-63C								●	●	●	●	●	●

- All products are provided with hex socket head cap screw.
- Recommended tolerance for shaft diameters is h6 and h7.

Performance

Part Number	Max. Bore Diameter (mm)	Rated *1 Torque (N·m)	Max. Rotational Frequency (min ⁻¹)	Moment *2 of Inertia (kg·m ²)	Static Torsional Stiffness (N·m/rad)	Max. Lateral Misalignment (mm)	Max. Angular Misalignment (°)	Max. Axial Misalignment (mm)	Mass *2 (g)
MHW-32C	10	2	19000	6.2×10 ⁻⁶	1000	0.15	2	±0.4	48
MHW-40C	14	4	15000	1.6×10 ⁻⁵	1500	0.2	2	±0.5	81
MHW-50C	20	7.5	12000	4.6×10 ⁻⁵	2000	0.2	2	±0.6	150
MHW-63C	25	10	10000	1.1×10 ⁻⁴	2500	0.3	2	±0.8	230

- *1: Correction of rated torque due to load fluctuation is not required.
- *2: These are values with max. bore diameter.

⚠ Precautions for Use

- In case of mounting on D-cut shaft, be careful about the position of the D-cut surface of the shaft. → P.xxxx
- There are sizes where the hex socket head bolt exceeds the hub outer diameter of the coupling and the rotating diameter is larger than the hub outer diameter. Please be careful of the interference of coupling. → P.xxxx

● Related Products

The Double-Disk type Flexible Coupling [XHW-C] is compatible with the servomotor with 350% instantaneous max. torque is available. → P.xxxx



● Part number specification

MHW-32C-8-10



Additional Keyway at Shaft Hole → P.xxxx Cleanroom Wash & Packaging → P.xxxx Change to Stainless Steel Screw → P.xxxx
Available / Add'l charge Please combine with Stainless Steel Screw Alteration Service Available / Add'l charge