

Structure

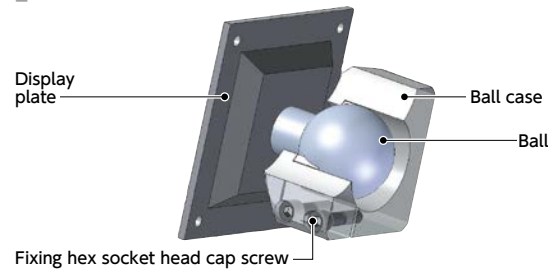

- The display can be tilted by $\pm 15^\circ$ to any direction over 360°. The display can also be rotated.

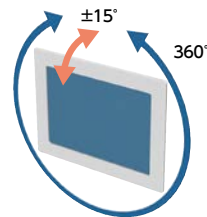

- By tightening the fixing hex socket head cap screw, securely retain the angle after adjustment.
- Three types of Mounting System for Display® are available for different types of mounting surfaces.



For aluminum frame /

For wall panel and sheet metal — **DFK-AF**

For aluminum frame end surface mounting — **DFK-AA**

For Round Pipe — **DFK-PB**

Application

Machine tool / Medical equipment / FPD production device / Semiconductor manufacturing device / Packing machine / Food machinery

Material/Finish



	DFK-AF	DFK-AA / DFK-PB
Display Plate	SPHC Electrostatic Coating	
Ball Case	A6063 Anodized	
Ball	S45C Trivalent Chromate Treatment	
Fixing Hex Socket Head Cap Screw (M5×16mm)	SCM435 Ferrosferric Oxide Film	
Fixing Plate	SS400 Electrostatic Coating	—
Bracket	—	A6063 Anodized

Related Products

DPU with pulls to allow smooth adjustment of the display angle is available.
→ P.xxxx



A 360° rotation type, spring type display mounting system **DFT** that can retain without bolt tightening is available.
→ P.xxxx



Part number specification

DFK-75-AA-40

Product Code **1** **2** **3**

Example of part number: DFK-100-AF-M8 / DFK-75-PB-40

- For aluminum frame / For wall panel and sheet metal

DFK-AF

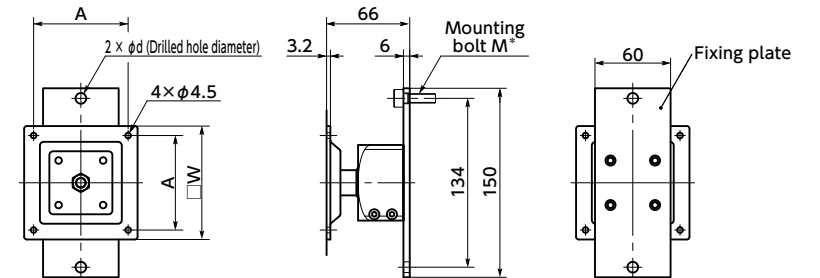

Unit : mm

Part Number	A 1	M* ¹ (d) 3	W	Mass (g)	Max. Load Weight
DFK-75-AF-**	75	M4 (5) M5 (6) M6 (7) M8 (9)	90	1130	10 kg
DFK-100-AF-**	100	M4 (5) M5 (6) M6 (7) M8 (9)	115	1230	10 kg

*1 : Mounting bolts are not supplied.

- For aluminum frame end surface mounting

DFK-AA

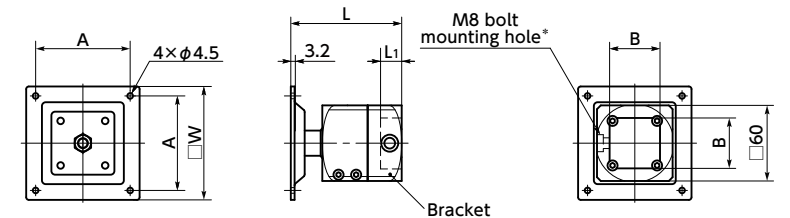

Unit : mm

Part Number	A 1	B 3	W	L1	L	Mass (g)	Max. Load Weight
DFK-75-AA-40	75	40	90	17	87	900	10kg
DFK-100-AA-40	100	40	115	17	87	1000	10kg

*1 : Hex socket low head bolts (M8 × 16 mm) are provided.

- For Round Pipe

DFK-PB

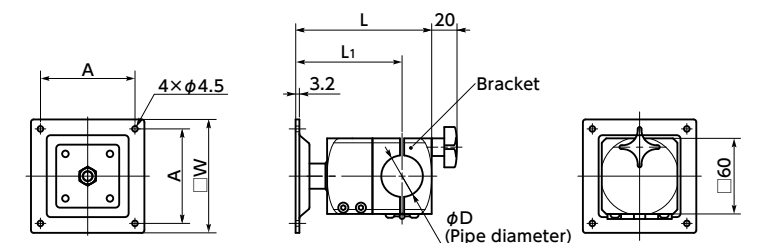

Part Number	A 1	D 3	W	L1	L	Mass (g)	Max. Load Weight		
DFK-75-PB-**	75	28	30	34	90	84	108	1010 - 1050	10 kg
		40	42.7		90	88	116	1000 - 1030	10 kg
DFK-100-PB-**	100	28	30	34	115	84	108	1110 - 1150	10 kg
		40	42.7		115	88	116	1100 - 1130	10 kg

• Fixing rubber sheet is attached. Dimensional allowance of available round pipe is ± 0.5 mm.