

SPA-LC Plastic Low Profile Socket Head Screws - RENY

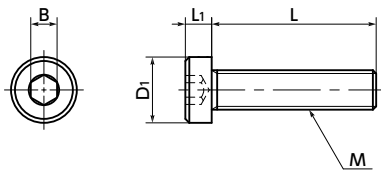

- Protrusion
- High strength
- Lightweight
- High Specific Strength



● Material/Finish



SPA-LC	
Main Body	RENY™*1 (50% Glass Fiber Reinforced Polyamide MXD6) (Black)
Heat Resistance Temperature*2	105°C

- *1: RENY™ is a trademark or registered trademark of Mitsubishi Gas Chemical Company, Inc.
- *2: This is the value for the resin material. The operating temperature of the product changes with performance conditions such as tightening torque.

● Part Number Specification

SPA-M5-30-LC



- RENY™ low profile cap screws.
- For space-saving of equipment/devices and applications with limited overhead space.
- RENY™ is a thermoplastic engineering plastic with excellent tensile and bending strength.
- It is highly fatigue-resistant and has excellent creep and heat insulation properties.
- While it is nearly as strong as metal, its weight is approximately 1/5 of iron.
- For the properties and precautions for use of plastic screws, see "Properties of Plastic Screws."

● Application

Heat insulation and dew condensation prevention of refrigerating and freezing facilities
 Electrical and electronic equipment / Offshore instruments / Plating facilities

Unit : mm

Part Number 1	M (Coarse)		L 2								D1	L1	B	Tensile Breaking Load*1 (N)	Torsional Torque*1 (N·m)	Mass (g)	Qty per Pack	
	Nominal of Thread	Pitch																
SPA-M3-LC	M3	0.5	6	8	10	12	16	20				5.5	2	2	799	0.2	0.11 - 0.25	20
SPA-M3-LC(100)	M3	0.5	6	8	10	12	16	20				5.5	2	2	799	0.2	0.11 - 0.25	100
SPA-M3-LC(1000)	M3	0.5	6	8	10	12	16	20				5.5	2	2	799	0.2	0.11 - 0.25	1000
SPA-M4-LC	M4	0.7	6	8	10	12	16	20	25			7	2.8	2.5	1286	0.74	0.24 - 0.58	20
SPA-M4-LC(100)	M4	0.7	6	8	10	12	16	20	25			7	2.8	2.5	1286	0.74	0.24 - 0.58	100
SPA-M4-LC(1000)	M4	0.7	6	8	10	12	16					7	2.8	2.5	1286	0.74	0.24 - 0.4	1000
SPA-M4-LC(500)	M4	0.7						20	25			7	2.8	2.5	1286	0.74	0.48 - 0.58	500
SPA-M5-LC	M5	0.8	6	8	10	12	16	20	25	30		8.5	3.5	3	1976	1.08	0.39 - 1	20
SPA-M5-LC(100)	M5	0.8	6	8	10	12	16	20	25	30		8.5	3.5	3	1976	1.08	0.39 - 1	100
SPA-M5-LC(500)	M5	0.8	6	8	10	12	16	20				8.5	3.5	3	1976	1.08	0.39 - 0.71	500
SPA-M5-LC(250)	M5	0.8							25	30		8.5	3.5	3	1976	1.08	0.87 - 1	250
SPA-M6-LC	M6	1			10	12	16	20	25	30	40	10	4	4	2767	2.26	0.75 - 2.1	20
SPA-M6-LC(100)	M6	1			10	12	16	20	25	30	40	10	4	4	2767	2.26	0.75 - 2.1	100
SPA-M6-LC(500)	M6	1			10	12	16					10	4	4	2767	2.26	0.75 - 0.96	500
SPA-M6-LC(250)	M6	1						20	25			10	4	4	2767	2.26	1.1 - 1.3	250
SPA-M6-LC(200)	M6	1								30		10	4	4	2767	2.26	1.5	200

- *1: Values in chart are for reference only. They are not guaranteed values. The recommended tightening torque is 50% of the torsional torque.
- When purchasing less volume than one full bag, a separate handling fee is charged. For details, see the Sold Separately Service.

Individual Sales Available / Add'l charge	Cleanroom Wash & Packaging Available / Add'l charge	Screw Length Adjustment Not Available	Vibration Resistant Not Available	Modification process for captive use Not Available
---	---	---------------------------------------	-----------------------------------	--