

SPA-SH Plastic Ultra Low Profile Hexalobular Socket Head Screws - RENY

Protrusion High strength Lightweight High Specific Strength

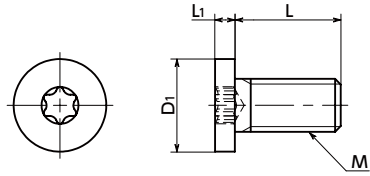

● Material/Finish



SPA-SH	
Main Body	RENY™*1 (50% Glass Fiber Reinforced Polyamide MXD6) (Black)
Heat Resistance Temperature*2	105°C

*1: RENY™ is a trademark or registered trademark of Mitsubishi Gas Chemical Company, Inc.

*2: This is the value for the resin material. The operating temperature of the product changes with performance conditions such as tightening torque.

- RENY™ special low profile cap screw. All head heights are 1.5mm or less.
- RENY™ is a thermoplastic engineering plastic with excellent tensile and bending strength.
- It is highly fatigue-resistant and has excellent creep and heat insulation properties.
- While it is nearly as strong as metal, its weight is approximately 1/5 of iron.
- The recess has a hexalobular*1 shape that can withstand high tightening torque.
- Install and remove with **SKX** Dedicated Wrench or **SKXB** Dedicated Bit and **SRD** Dedicated Magnetic Screwdriver together.
- Use the **SKX-N** hexalobular wrench for extremely limited access spaces for mounting and removing in tight spaces.
- For the properties and precautions of plastic screws, please refer to "Properties of Plastic Screws".

*1: The hexalobular shape is prescribed by JIS B 1015: 2008(ISO 10664: 2005)"Hexalobular internal driving feature for bolts and screws".

● Application

Heat insulation and dew condensation prevention of refrigerating and freezing facilities
Electrical and electronic equipment / Offshore instruments / Plating facilities



Unit : mm

Part Number	M (Coarse)		L	D1	L1	Applicable Wrench	Hexalobular Socket No.	Tensile Breaking Load*1 (N)	Torsional Torque*1 (N·m)	Mass (g)	Qty per Pack
	Nominal of Thread	Pitch									
SPA-M3-SH	M3	0.5	6 8 10 12 16 20	6	1.3	SKX-8	8	596	0.25	0.098 - 0.22	20
SPA-M3-SH(100)	M3	0.5	6 8 10 12 16 20	6	1.3	SKX-8	8	596	0.25	0.098 - 0.22	100
SPA-M3-SH(1000)	M3	0.5	6 8 10 12 16 20	6	1.3	SKX-8	8	596	0.25	0.098 - 0.22	1000
SPA-M4-SH	M4	0.7	6 8 10 12 16 20 25	8	1.5	SKX-10	10	1004	0.53	0.19 - 0.48	20
SPA-M4-SH(100)	M4	0.7	6 8 10 12 16 20 25	8	1.5	SKX-10	10	1004	0.53	0.19 - 0.48	100
SPA-M4-SH(1000)	M4	0.7	6 8 10 12 16	8	1.5	SKX-10	10	1004	0.53	0.19 - 0.34	1000
SPA-M4-SH(500)	M4	0.7	20 25	8	1.5	SKX-10	10	1004	0.53	0.41 - 0.48	500
SPA-M5-SH	M5	0.8	6 8 10 12 16 20 25 30	9	1.5	SKX-15	15	1543	0.95	0.27 - 0.87	20
SPA-M5-SH(100)	M5	0.8	6 8 10 12 16 20 25 30	9	1.5	SKX-15	15	1543	0.95	0.27 - 0.87	100
SPA-M5-SH(500)	M5	0.8	6 8 10 12 16 20	9	1.5	SKX-15	15	1543	0.95	0.27 - 0.62	500
SPA-M5-SH(250)	M5	0.8	25 30	9	1.5	SKX-15	15	1543	0.95	0.8 - 0.87	250
SPA-M6-SH	M6	1	10 12 16 20 25 30 40	10	1.5	SKX-20	20	1654	1.27	0.5 - 1.55	10
SPA-M6-SH(100)	M6	1	10 12 16 20 25 30 40	10	1.5	SKX-20	20	1654	1.27	0.5 - 1.55	100
SPA-M6-SH(500)	M6	1	10 12 16	10	1.5	SKX-20	20	1654	1.27	0.5 - 0.71	500
SPA-M6-SH(250)	M6	1	20 25	10	1.5	SKX-20	20	1654	1.27	0.86 - 1.02	250
SPA-M6-SH(200)	M6	1	30	10	1.5	SKX-20	20	1654	1.27	1.18	200

*1: Values in chart are for reference only. They are not guaranteed values. The recommended tightening torque is 50% of the torsional torque.

● When purchasing less volume than one full bag, a separate handling fee is charged. For details, see the Sold Separately Service.

Individual Sales Available / Add'l charge	Cleanroom Wash & Packaging Available / Add'l charge	Screw Length Adjustment Not Available	Vibration Resistant Not Available	Modification process for captive use Not Available
---	---	---------------------------------------	-----------------------------------	--

● Related Products

RENY™ hex nuts and washers **SPA-N** **SPA-W** are available.



SKX Hexalobular Wrench



SKX-N Hexalobular Wrench for Extremely Limited Access Spaces



SKXB Hexalobular Short Bit



SRD Magnet Screwdriver



● Part Number Specification

SPA-M5-30-SH

1 2 3