

SPE-LC Plastic Low Profile Socket Head Screws - PEEK

Protrusion
 Heat-resistance
 Chemical-proof
 Electrical Insulation

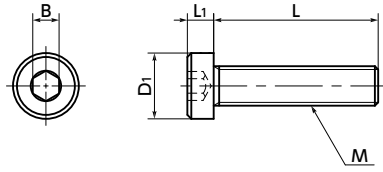

● Material/Finish



SPE-LC	
Main Body	PEEK (Polyether Ether Ketone) (Light Brown)
Heat Resistance Temperature*1	260°C

*1: This is the value for the resin material. The operating temperature of the product changes with performance conditions such as tightening torque.

Precautions for Use

Because a cumulative pitch difference is created when PEEK screws are manufactured, use these screws with nuts. If a nut is not used, use a 20 mm or less fit with female thread.

- PEEK low profile cap screws.
- For space-saving of equipment/devices and applications with limited overhead space.
- PEEK is a thermoplastic super engineering plastic superior in physical and chemical properties.
- Excellent chemical resistance. It remains almost unaffected by chemicals other than concentrated sulfuric acid, concentrated nitric acid, and concentrated hydrofluoric acid.
- With excellent heat resistance and water resistance, it retains strength at high temperatures.
- It features outstanding resistance to wear, shock, and fatigue.
- It also has high flame retardance which clears the UL 94 V-0 standard.
- For the properties and precautions for use of plastic screws, see "Properties of Plastic Screws."

● Application

FPD production device / Semiconductor manufacturing device / Print board etching equipment / Metal surface treatment facility / Chemical plant / Transformer / Electric and electronic device / Hydrothermal pump / Chemical pump



Unit : mm

Part Number	M (Coarse)		L	D1	L1	B	Tensile Breaking Load*1 (N)	Torsional Torque*1 (N·m)	Mass (g)	Qty per Pack
	Nominal of Thread	Pitch								
SPE-M3-LC	M3	0.5	6 8 10 12 16 20	5.5	2	2	400	0.13	0.09 - 0.2	10
SPE-M3-LC(100)	M3	0.5	6 8 10 12 16 20	5.5	2	2	400	0.13	0.09 - 0.2	100
SPE-M4-LC	M4	0.7	6 8 10 12 16 20 25	7	2.8	2.5	744	0.47	0.19 - 0.46	10
SPE-M4-LC(100)	M4	0.7	6 8 10 12 16 20 25	7	2.8	2.5	744	0.47	0.19 - 0.46	100
SPE-M5-LC	M5	0.8	6 8 10 12 16 20 25 30	8.5	3.5	3	1272	0.68	0.26 - 0.81	10
SPE-M5-LC(100)	M5	0.8	6 8 10 12 16 20 25 30	8.5	3.5	3	1272	0.68	0.26 - 0.81	100
SPE-M6-LC	M6	1	10 12 16 20 25 30 40	10	4	4	1727	1.36	0.58 - 1.6	5
SPE-M6-LC(100)	M6	1	10 12 16 20 25 30 40	10	4	4	1727	1.36	0.58 - 1.6	100

*1: Values in chart are for reference only. They are not guaranteed values. The recommended tightening torque is 50% of the torsional torque.

● When purchasing less volume than one full bag, a separate handling fee is charged. For details, see the Sold Separately Service.

● Related Products

PEEK hex nuts **SPE-N** are available.



● Part Number Specification

SPE-M5-30-LC

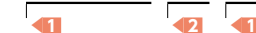

Individual Sales Available / Add'l charge	Cleanroom Wash & Packaging Available / Add'l charge	Screw Length Adjustment Available / Add'l charge	Vibration Resistant Not Available	Modification process for captive use Please feel free to contact us
--	--	---	--------------------------------------	--