

SSH Hex Socket Head Cap Screws with Special Low Profile

WEB Selection Tool WEB CAD Download Protrusion

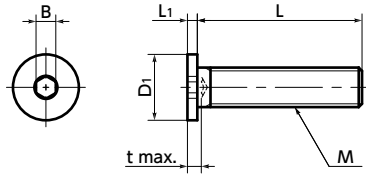

- Material/Finish RoHS2 Compliant

	SSH	SSH-EL
Main Body	SCM435 Ferrosoferric Oxide Coating (Black)	SCM435 Electroless Nickel Plating
Strength Class	Thread : 10.9 Head*1 : 5.8 (M2 - M8) 4.8 (M10)	Thread : 10.9 Head*1 : 5.8 (M2 - M8) 4.8 (M10)

*1 : Do not exceed the max. tightening torque. Though strength is increased through heat treatment, the head strength is less than that of thread.

- The head height for all screws is 1.5 mm or less.
- Intended for reducing the size of devices and applications with limited overhead space.
- Also, **SVSHS** Socket Head Cap Screws with Special Low Profile with Ventilation Hole (→ P.xxxx), and **SSH-FT** Socket Head Cap Screws with Special Low Profile with long thread (→ P.xxxx) are available.

Application

Reducing the size of equipment and devices

SSH Made of Steel · Ferrosoferric Oxide Film

Unit : mm

Part Number	M (Coarse)		L										D1	L1	B	t	Max. Torque (N·m)	Mass (g)
	Nominal of Thread	Pitch	4	5	6	8	10	12	16	20	25	30						
SSH-M2	M2	0.4	4	5	6	8	10	12					4	1.1	1.3	1.2	0.3	0.11 - 0.29
SSH-M2.5	M2.5	0.45	4	5	6	8	10	12					5	1.3	1.3	1.5	0.4	0.23 - 0.47
SSH-M3	M3	0.5	4	5	6	8	10	12					6	1.3	1.5	2	0.7	0.36 - 0.69
SSH-M4	M4	0.7			6	8	10	12	16	20			8	1.5	2	2.5	1.7	0.89 - 1.9
SSH-M5	M5	0.8			6	8	10	12	16	20	25		9	1.5	3	3	6.2	0.73 - 3.1
SSH-M6	M6	1			6	8	10	12	16	20	25	30	10	1.5	3	4	6.3	1.2 - 5.5
SSH-M8	M8	1.25				8	10	12	16	20	25	30	13	1.5	4	5	14	3 - 10
SSH-M10	M10	1.5					10	12	16	20	25	30	16	1.5	5	6	27	4.6 - 15

Part Number	Qty*1 per pack
SSH-M2	10
SSH-M2.5	10
SSH-M3	10
SSH-M4	10
SSH-M5	10
SSH-M6	10
SSH-M8	10
SSH-M10	10

*1 : Also sold separately from 1 piece up. → P.xxxx

SSH-EL Made of Steel · Electroless Nickel Plating

Unit : mm

Part Number	M (Coarse)		L										D1	L1	B	t	Max. Torque (N·m)	Mass (g)
	Nominal of Thread	Pitch	4	5	6	8	10	12	16	20	25	30						
SSH-M2-EL	M2	0.4	4	5	6	8	10	12					4	1.1	1.3	1.2	0.3	0.11 - 0.29
SSH-M2.5-EL	M2.5	0.45	4	5	6	8	10	12					5	1.3	1.3	1.5	0.4	0.23 - 0.47
SSH-M3-EL	M3	0.5	4	5	6	8	10	12					6	1.3	1.5	2	0.7	0.36 - 0.69
SSH-M4-EL	M4	0.7			6	8	10	12	16	20			8	1.5	2	2.5	1.7	0.89 - 1.9
SSH-M5-EL	M5	0.8			6	8	10	12	16	20	25		9	1.5	3	3	6.2	0.73 - 3.1
SSH-M6-EL	M6	1			6	8	10	12	16	20	25	30	10	1.5	3	4	6.3	1.2 - 5.5
SSH-M8-EL	M8	1.25				8	10	12	16	20	25	30	13	1.5	4	5	14	3 - 10
SSH-M10-EL	M10	1.5					10	12	16	20	25	30	16	1.5	5	6	27	4.6 - 15

Part Number	Qty*1 per pack
SSH-M2-EL	10
SSH-M2.5-EL	10
SSH-M3-EL	10
SSH-M4-EL	10
SSH-M5-EL	10
SSH-M6-EL	10
SSH-M8-EL	10
SSH-M10-EL	10

*1 : Also sold separately from 1 piece up. → P.xxxx

Part number specification

SSH-M5-20-EL

Product Code

Order in number of packs.

Also sold separately from 1 piece up. → P.xxxx

Individual Sales → P.xxxx Cleanroom Wash & Packaging → P.xxxx Screw Length Adjustment → P.xxxx Vibration Resistant → P.xxxx Modification process for captive use → P.xxxx
 Available / Add'l charge Please feel free to contact us Available / Add'l charge Available / Add'l charge Not Available