

SPE-PS(INCH)Plastic Screws - Slotted Pan Head Machine Screws - PEEK - Inch Thread **NEW**WEB Selection
ToolWEB CAD
Download

Chemical-proof

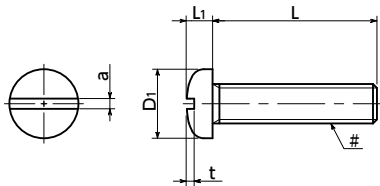

● Material/Finish

RoHS2 Compliant

	SPE-PS(INCH)
Main Body	PEEK / Light Brown
Heat Resistance Temperature*1	180°C

*1: This is the value for the resin material. The operating temperature of the product changes with performance conditions such as tightening torque.

⚠ Precautions for Use

Because a cumulative pitch difference is created when PEEK screws are manufactured, use these screws with nuts. If a nut is not used, use a 20 mm (approx. 0.79") or less fit with female thread.

● Inch screw type.

- PEEK is a thermoplastic super engineering plastic superior in physical and chemical properties.
- Excellent chemical resistance. It remains almost unaffected by chemicals other than concentrated sulfuric acid, concentrated nitric acid, and concentrated hydrofluoric acid.
- With excellent heat resistance and water resistance, it retains strength at high temperatures.
- It features outstanding resistance to wear, shock, and fatigue.
- It also has high flame retardance which clears the UL 94 V-0 standard.
- Plastic screw properties and precautions for use
➔ P.xxxx

● Application

FPD production equipment / Semiconductor devices / Printed circuit board etching devices / Metallic surface treatment equipment and facilities / Chemical plants / Transformers / Electrical and electronic equipment / Hot water pumps / Chemical pumps

Unit : inch

Part Number	#Nominal of Thread	L	D1	L1	a	t	Tension Rupture Load*1 (N)	Torsional Torque*1 (N·m)	Mass (g)
SPE-#4-40-PS	No.4-40UNC	1/4 5/16 3/8 1/2 5/8 3/4 7/8 1	0.219	0.068	0.039	0.040	288	0.17	0.078 - 0.14
SPE-#6-32-PS	No.6-32UNC	1/4 5/16 3/8 1/2 5/8 3/4 7/8 1	0.270	0.082	0.048	0.050	431	0.34	0.17 - 0.29
SPE-#8-32-PS	No.8-32UNC	1/4 5/16 3/8 1/2 5/8 3/4 7/8 1	0.322	0.096	0.054	0.058	703	0.62	0.27 - 0.39
SPE-#10-32-PS	No.10-32UNF	3/8 1/2 5/8 3/4 7/8 1	0.373	0.110	0.060	0.068	1064	1.06	0.36 - 0.66

*1: Values in chart are for reference only. They are not guaranteed values. The recommended tightening torque is 50% of the torsional torque.

Part Number	per Pack Qty
SPE-#4-40-PS	10
SPE-#6-32-PS	10
SPE-#8-32-PS	10
SPE-#10-32-PS	10

● Related Products

PEEK hex nuts (inch thread)
SPE-N(INCH) are available.

➔ P.xxxx



● Part number specification

SPE-#4-40-1/4-PS

1 2 1

Order in number of packs.

The minimum order quantity is 1 piece. ➔ P.xxxx

1 Individual Sales ➔ P.xxxx	Cleanroom Wash & Packaging ➔ P.xxxx	Screw Length Adjustment ➔ P.xxxx	Vibration Resistant ➔ P.xxxx	Modification process for captive use ➔ P.xxxx
Available / Add'l charge	Available / Add'l charge	Available / Add'l charge	Not Available	Not Available