

# SSHS-UCL Socket Head Cap Screws with Ultra Low Profile - Cleanroom Washed & Packaged

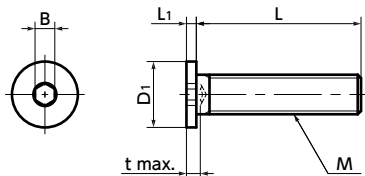

Protrusion Cleanroom wash & packaging SUS Stainless steel



● Material/Finish



SSHS-UCL	
Main Body	SUSXM7 (Equivalent to SUS304) USC Cleaning
Strength Class	A2 - 50



- SUSXM7 hex socket head cap screw with special low profile.
- All head heights are 1.5 mm or less. For space-saving of equipment/devices and applications with limited overhead space.
- Cleanroom washed (ultrasonic cleaning) and cleanroom packaged.
- For parts embedded in FPD production devices, semiconductor manufacturing devices, medical equipment, or food machinery, or used in cleanrooms.
- SUS316L **SSHL-UCL** is available.

**SSHL-UCL**

**SSHS-UCL**



To distinguish it from **SSHS-UCL**, **SSHL-UCL** has a cup point tip.

● Application

Reducing the size of equipment and devices  
 FPD manufacturing equipment / Semiconductor manufacturing equipment /  
 Medical equipment / Food related machinery

Unit : mm

Part Number <sup>1</sup>	M (Coarse)		L <sup>2</sup>										D1	L1	B	t max.	Mass (g)	Qty per Pack	
	Nominal of Thread	Pitch																	
<b>SSHS-M2-UCL</b>	M2	0.4	4	5	6	8	10	12						4	1.1	1.3	1.2	0.11 - 0.29	10
<b>SSHS-M2.5-UCL</b>	M2.5	0.45	4	5	6	8	10	12						5	1.3	1.3	1.5	0.23 - 0.47	10
<b>SSHS-M3-UCL</b>	M3	0.5	4	5	6	8	10	12						6	1.3	1.5	2	0.36 - 0.69	10
<b>SSHS-M4-UCL</b>	M4	0.7			6	8	10	12	16					8	1.5	2	2.5	0.89 - 1.6	10
<b>SSHS-M5-UCL</b>	M5	0.8			6	8	10	12	16	20	25			9	1.5	3	3	0.73 - 3.3	10
<b>SSHS-M6-UCL</b>	M6	1			6	8	10	12	16	20	25	30		10	1.5	3	4	1.2 - 5.5	10

● When purchasing less volume than one full bag, a separate handling fee is charged. For details, see the Sold Separately Service.

● Part Number Specification

**SSHS-M5-12-UCL**



<b>1</b> Individual Sales	<b>2</b> Cleanroom Wash & Packaging	<b>3</b> Screw Length Adjustment	<b>4</b> Vibration Resistant	<b>5</b> Modification process for captive use
Available / Add'l charge	Cleanroom washed and packed	Available / Add'l charge	Not Available	Not Available