

# SVSH-C276 Vented Socket Head Cap Screws - Hastelloy C - 276 equiv.

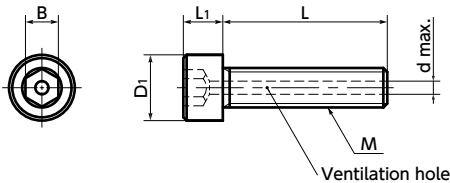

Vacuum 
 Cleanroom wash & packaging 
 Chemical-proof



## ● Mechanical property

	Hastelloy (UNS N10276)	SUS304
Tensile Strength (N/mm <sup>2</sup> )	690 or More	520 or More
0.2% Proof Load (N/mm <sup>2</sup> )	283 or More	205 or More
Elongation (%)	40 or More	40 or More

● Values in chart are for reference only. They are not guaranteed values.

## ● Physical property

	Hastelloy (UNS N10276)	SUS304
Specific Gravity	8.89	7.93
Longitudinal Elastic Modulus (GPa)	205	193
Specific Heat (J/kg·K)	427	500
Electric Resistance (μΩ·m)	1.23	0.7
Linear Expansion Coefficient (K <sup>-1</sup> )	11.2×10 <sup>-6</sup>	17.3×10 <sup>-6</sup>

● Values in chart are for reference only. They are not guaranteed values.

- Hastelloy C-276 hex socket head cap screws **SVSH-C276** with ventilation hole.
- The ventilation hole easily releases gas trapped in the screw holes of equipment and machines, and supports vacuum drawing of vacuum devices.
- Hastelloy C-276 is the standard Hastelloy type.
- Excellent corrosion resistance against oxidizing and reducing salts.
- Supports use with vacuum equipment in corrosive environments.
- Cleanroom wash/cleanroom packing provided.
- Hastelloy C-22 hex socket head cap screws with ventilation hole **SVSH-C22**, resistant to wet chlorine gas, hypochlorite, and chlorine dioxide, are available.

## ● Application

Vacuum devices / Vacuum chambers / FPD production equipment / Semiconductor manufacturing equipment / Electron microscopes / Printed circuit board etching devices / Metallic surface treatment equipment and facilities / Chemical plants

## ● Material/Finish



	SVSH-C276
Main Body	UNS N10276 (Hastelloy*1C-276 equiv.)

\*1: Hastelloy is a registered trademark of Haynes International, Inc.

Unit : mm

Part Number <sup>1</sup>	M (Coarse)		L <sup>2</sup>								D1	L1	B	d max.	Mass (g)	
	Nominal of Thread	Pitch	6	8	10	12	16	20	25	30						35
<b>SVSH-M3-C276</b>	M3	0.5	6	8	10	12	16	20				5.5	3	2.5	1.2	0.81 - 1.6
<b>SVSH-M4-C276</b>	M4	0.7		8	10	12	16	20	25			7	4	3	1.5	1.9 - 3.6
<b>SVSH-M5-C276</b>	M5	0.8			10	12	16	20	25			8.5	5	4	1.5	3.1 - 5.4
<b>SVSH-M6-C276</b>	M6	1				12	16	20	25	30		10	6	5	2	5.8 - 9.5
<b>SVSH-M8-C276</b>	M8	1.25					16	20	25	30	35	13	8	6	2	14 - 22

## ● Part number specification

### SVSH-M5-16-C276

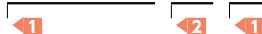

Batch cleanroom packing is provided for orders containing multiple items of the same size.

Individual Sales 1 piece in 1 pack	Cleanroom Wash & Packaging Cleanroom washed and packed	Screw Length Adjustment Please feel free to contact us	Vibration Resistant Not Available	Modification process for captive use Please feel free to contact us
---------------------------------------	---	---	--------------------------------------	--