

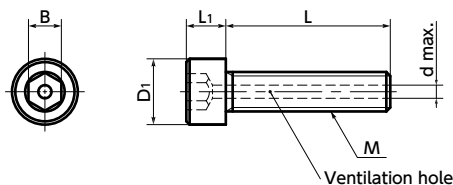

SVSI Vented Socket Head Cap Screws - Inconel equiv.

- Vacuum
- Cleanroom wash & packaging
- Heat-resistance
- Chemical-proof



Material/Finish



	SVSI
Main Body	UNS N06600 (Inconel*1600 equiv.)

*1 : Inconel is a registered trademark of Special Metals Corporation.

Mechanical property

	Inconel (UNS N06600)	SUS304
Tensile Strength (N/mm ²)	548 - 695	520 or More
0.2% Proof Load (N/mm ²)	205 - 352	205 or More
Elongation (%)	35 - 55	40 or More
Hardness (HRB)	65 - 85	90 or Less

• Values in chart are for reference only. They are not guaranteed values.

Physical property

	Inconel (UNS N06600)	SUS304
Specific Gravity	8.42	7.93
Longitudinal Elastic Modulus (GPa)	207	193
Specific Heat (J/kg·K)	444	500
Electric Resistance (μΩ·m)	1.0	0.7
Thermal Conductivity (W/(m·K))	16.7	17
Linear Expansion Coefficient (K ⁻¹)	13.4 × 10 ⁻⁶	17.3 × 10 ⁻⁶

• Values in chart are for reference only. They are not guaranteed values.

- Inconel hex socket head cap screws **SVSI** with ventilation hole.
- The ventilation hole easily releases gas trapped in the screw holes of equipment and machines, and supports vacuum drawing of vacuum devices.
- Excellent corrosion resistance against oxidizing and reducing organic and inorganic acids. ➔ P.xxxx
- Excellent resistance to stress corrosion cracking due to chlorine ions.
- Demonstrates almost total corrosion resistance to ammonia.
- Excellent heat resistance and creep resistance. Retains high strength even near 600°C.
- Supports use with vacuum equipment in high-temperature and corrosive environments.
- Cleanroom wash/cleanroom packing provided. ➔ P.xxxx

Application

Vacuum devices / Vacuum chambers / FPD production equipment / Semiconductor manufacturing equipment / Electron microscopes / Printed circuit board etching devices / Metallic surface treatment equipment and facilities / Chemical plants

Unit : mm

Part Number	M (Coarse)		L	D1	L1	B	d max.	Mass (g)
	Nominal of Thread	Pitch						
SVSI-M3	M3	0.5	6 8 10 12 16 20	5.5	3	2.5	1.2	0.77 - 1.5
SVSI-M4	M4	0.7	8 10 12 16 20 25	7	4	3	1.5	1.8 - 3.4
SVSI-M5	M5	0.8	10 12 16 20 25 30	8.5	5	4	1.5	2.9 - 5.2
SVSI-M6	M6	1	12 16 20 25 30 35	10	6	5	2	5.5 - 9
SVSI-M8	M8	1.25	16 20 25 30 35	13	8	6	2	13 - 21

Part number specification

SVSI-M5-16



Batch cleanroom packing is provided for orders containing multiple items of the same size.

Individual Sales ➔ P.xxxx	Cleanroom Wash & Packaging ➔ P.xxxx	Screw Length Adjustment ➔ P.xxxx	Vibration Resistant ➔ P.xxxx	Modification process for captive use ➔ P.xxxx
1 piece in 1 pack	Cleanroom washed and packed	Please feel free to contact us	Not Available	Please feel free to contact us